

P.L. 94-171 VOTING DISTRICT/STATE LEGISLATIVE DISTRICT OUTLINE MAP (CENSUS 2000)

39 362656N  
92 475106W

39 362656N  
92 066389W

### GEOGRAPHIC AREAS LEGEND

SYMBOL	NAME STYLE
*****	INTERNATIONAL
=====	STATE
-----	COUNTY
-----	MINOR CIVIL DIV <sup>1</sup>
-----	Incorporated Place <sup>1</sup>
-----	Census Designated Place <sup>2</sup>
-----	Voting District
●●●●●	SLD-Senate
▲▲▲▲▲	SLD-House
-----	Minority
-----	Inset
-----	Out Area

Abbreviation Reference: AIR - American Indian Reservation; SDAISA - State Designated American Indian Statistical Area

<sup>1</sup> A "\*" following a place name indicates that the place is coextensive with a MCD. A "-" indicates that the place is also a MCD. In both cases, the MCD name is shown only when it differs from the place name.

<sup>2</sup> A "\*" following a VTD code indicates an actual voting district. Its absence indicates that the VTD is a pseudo voting district or no information is available as to its status.

### Voting Districts

Code	Name
2*	Voting District 4-H
7*	Free Voting District
23*	Thru Voting District

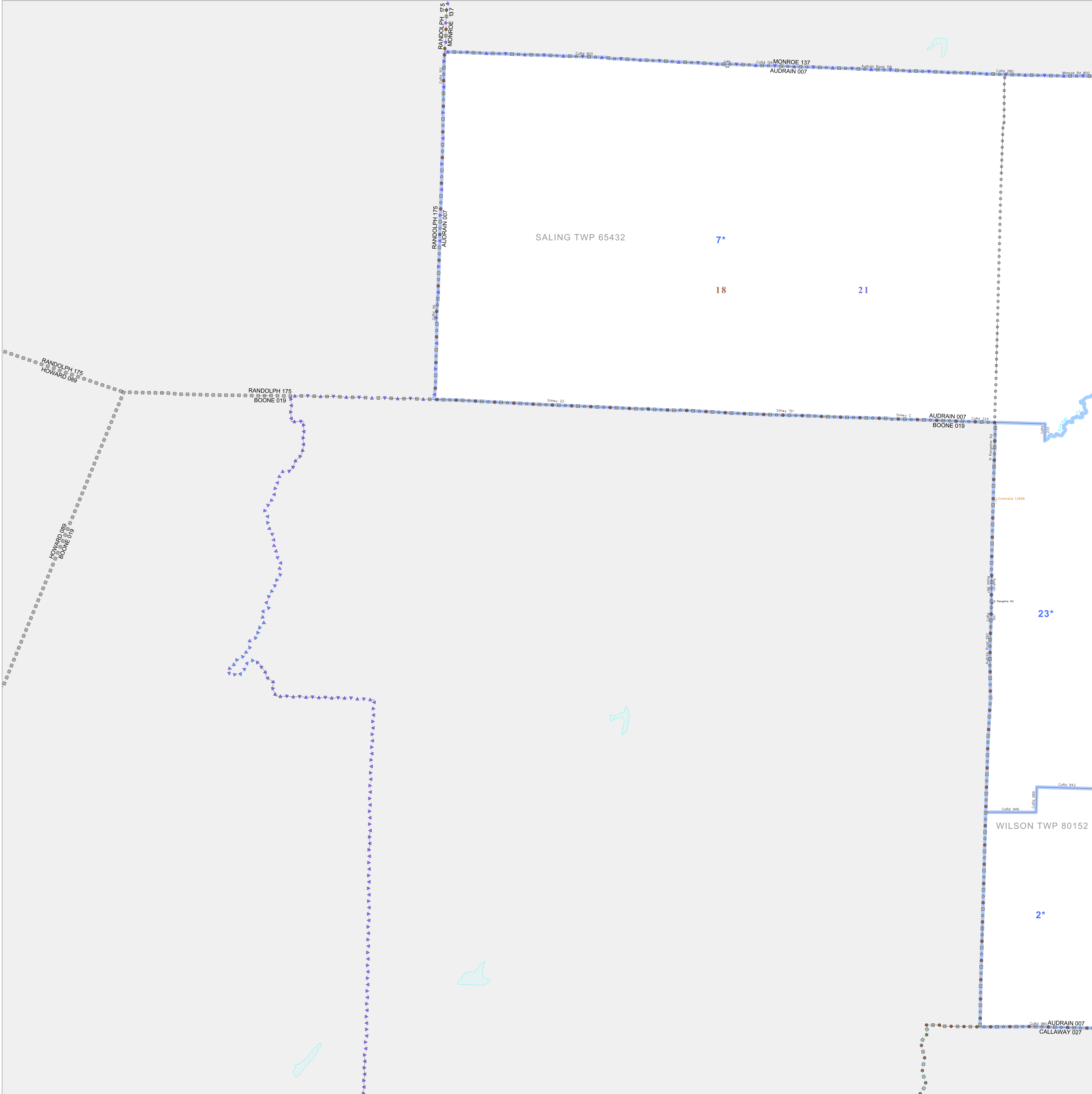

39 044176N  
92 475106W

39 044176N  
92 066389W

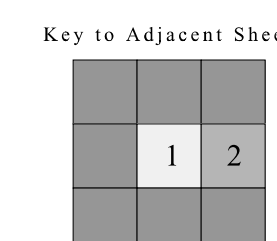
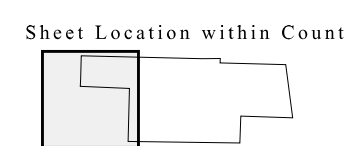
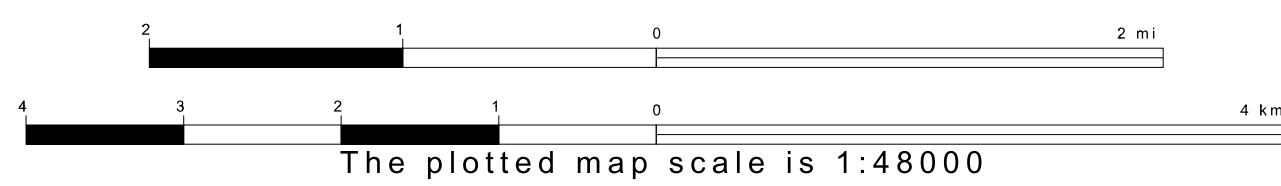

ST: Missouri (29)  
COU: Audrain (007)  
SHEET 1 OF 3 PARENT SHEETS