

P.L. 94-171 VOTING DISTRICT/STATE LEGISLATIVE DISTRICT OUTLINE MAP (CENSUS 2000)

36 854213N
93 823496W

36 854213N
93 828695W

GEOGRAPHIC AREAS LEGEND

SYMBOL	NAME STYLE
*****	INTERNATIONAL
//////	STATE
□□□□	COUNTY
○ ○ ○ ○	MINOR CIVIL DIV. ¹
■ ■ ■ ■	Incorporated Place ¹
■ ■ ■ ■	Census Designated Place ²
▬▬▬▬	Voting District
● ● ● ●	SLD-Senate
▲ ▲ ▲ ▲	SLD-House

Abbreviation Reference: AIR - American Indian Reservation; SDAISA - State Designated American Indian Statistical Area

¹ A "*" following a place name indicates that the place is consecutive with a MCD. A "-" indicates that the place is also a false MCD. In both cases, the MCD name is shown only when it differs from the place name.
² A "*" following a VTD code indicates an actual voting district. Its absence indicates that the VTD is a pseudo voting district or no information is available as to its status.

Voting Districts

Code	Name
5*	CraneCreekA Voting District
8*	FlatCreek/MN Voting District
9*	Jenkins Voting District
13*	Ozark Voting District
14*	PleasantRidge Voting District
15*	Purdy Voting District

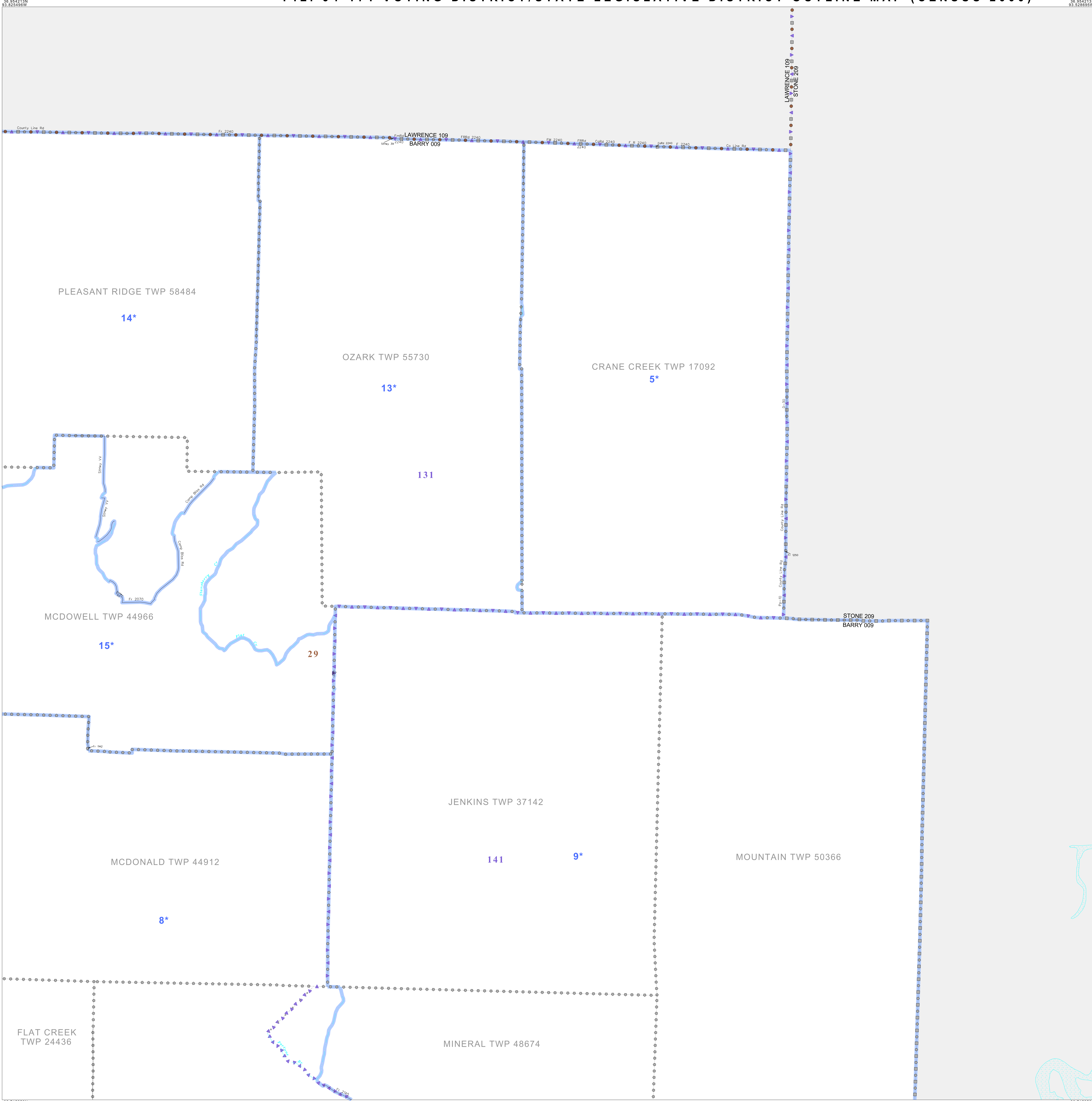

36 715250N
93 825496W

36 715250N
93 828695W

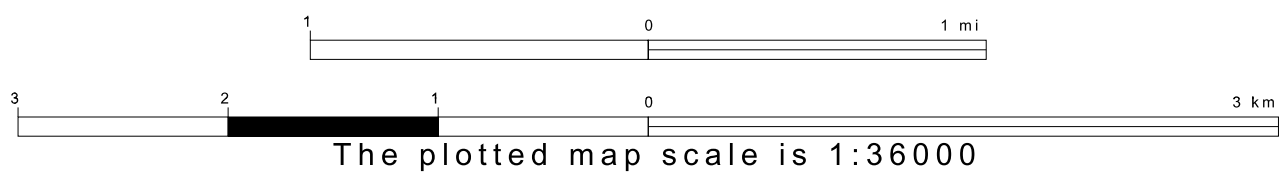

Sheet Location within County

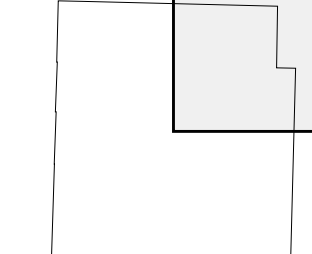

Key to Adjacent Sheets

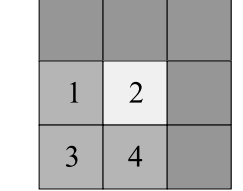

ST: Missouri (29)
COU: Barry (009)
SHEET 2 OF 4 PARENT SHEETS

