

P.L. 94-171 VOTING DISTRICT/STATE LEGISLATIVE DISTRICT OUTLINE MAP (CENSUS 2000)

38 745772N  
94 211676W

38 745772N  
93 957846W

### GEOGRAPHIC AREAS LEGEND

SYMBOL	NAME STYLE
*****	INTERNATIONAL
//////	STATE
□□□□	COUNTY
○ ○ ○ ○	MINOR CIVIL DIV. <sup>1</sup>
■ ■ ■ ■	Incorporated Place <sup>1</sup>
■ ■ ■ ■	Census Designated Place <sup>2</sup>
—	Voting District
● ● ● ●	SLD-Senate
▲ ▲ ▲ ▲	SLD-House
⋯	Minority
⋯	Inset
⋯	Out Area

Abbreviation Reference: AIR - American Indian Reservation; SDAISA - State Designated American Indian Statistical Area

<sup>1</sup> A "\*" following a place name indicates that the place is coterminous with a MCD. A "-" indicates that the place is also a false MCD. In both cases, the MCD name is shown only when it differs from the place name.

<sup>2</sup> A "\*" following a VTD code indicates an actual voting district. Its absence indicates that the VTD is a pseudo voting district or no information is available as to its status.

### Voting Districts

Code	Name
13*	CampBranchE Lynn15 Voting District
14*	CampBranchGross14 Voting District
15*	Dayton2 Voting District
17*	Dayton2A Voting District
25*	IndexGardenCity16 Voting District
26*	IndexGardenCity17 Voting District
31*	Park18 Voting District
34*	Sherman1 Voting District
42*	Sherman1 Voting District

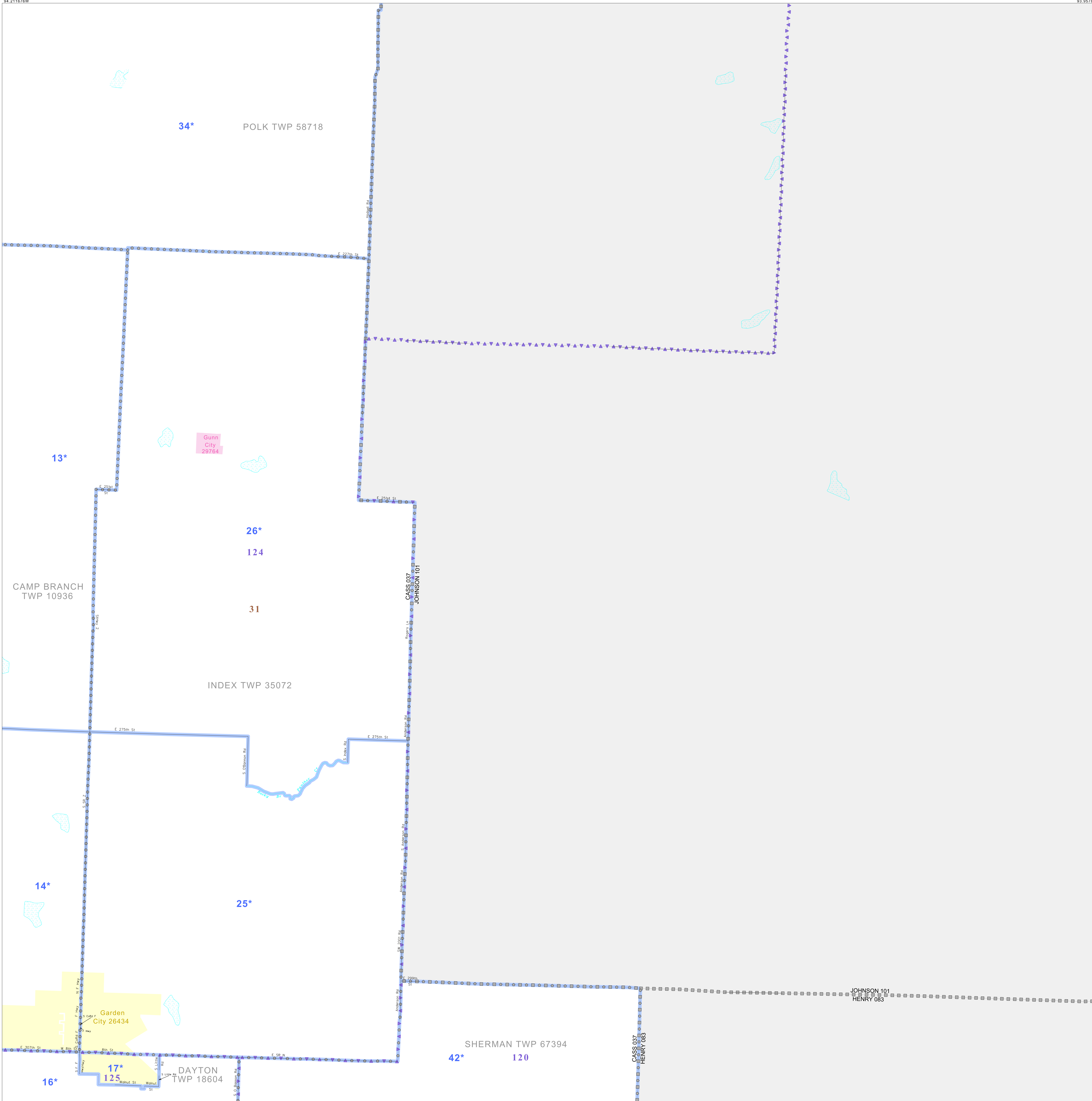

38 548703N  
94 211676W

38 548703N  
93 957846W

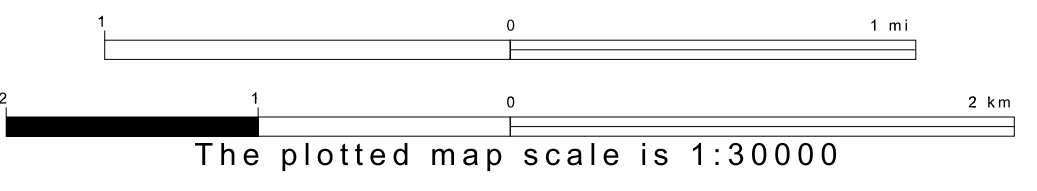

Sheet Location within County

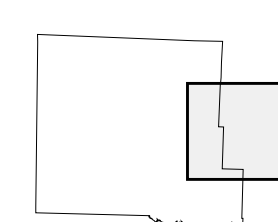

Key to Adjacent Sheets

2	3
5	6
8	9

ST: Missouri (29)  
COU: Cass (037)  
SHEET 6 OF 9 PARENT SHEETS

