

P.L. 94-171 VOTING DISTRICT/STATE LEGISLATIVE DISTRICT OUTLINE MAP (CENSUS 2000)

38 792656N  
93 084798W

38 792656N  
92 881092W

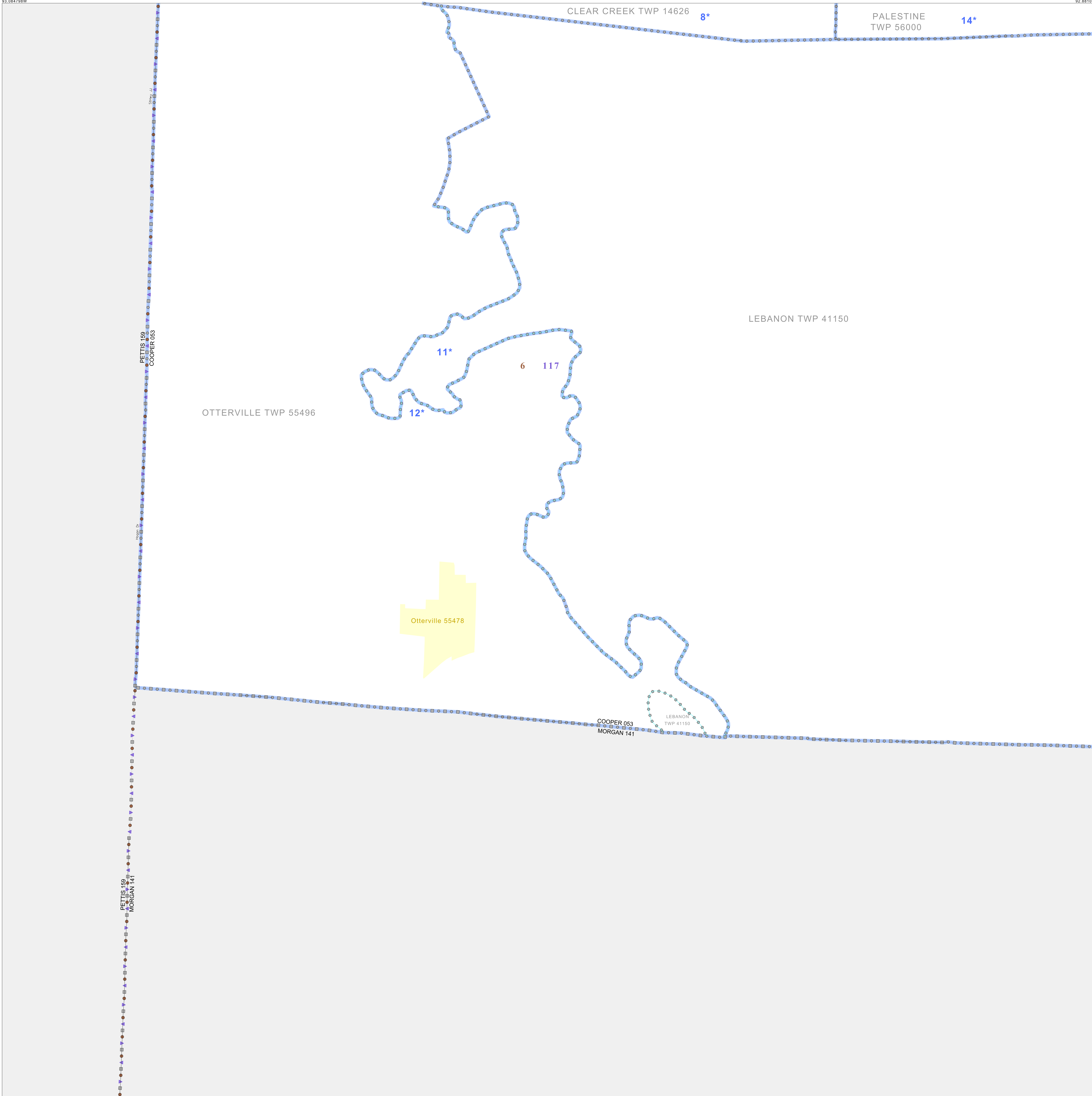

GEOGRAPHIC AREAS LEGEND

SYMBOL	NAME STYLE
*****	INTERNATIONAL
//////	STATE
□□□□	COUNTY
○	MINOR CIVIL DIV <sup>1</sup>
■	Incorporated Place <sup>1</sup>
■	Census Designated Place <sup>2</sup>
—	Voting District
●	SLD-Senate
▲	SLD-House

Abbreviation Reference: AIR - American Indian Reservation; SDAISA - State Designated American Indian Statistical Area

<sup>1</sup> A "\*" following a place name indicates that the place is coterminous with a MCD. A "-" indicates that the place is also a MCD. In both cases, the MCD name is shown only when it differs from the place name.  
<sup>2</sup> A "\*" following a VTD code indicates an actual voting district. Its absence indicates that the VTD is a pseudo voting district or no information is available as to its status.

Voting Districts

Code	Name
8*	ClearCreek Voting District
11*	Lebanon Voting District
12*	Otterville Voting District
14*	Palestine Voting District

38 833407N  
93 084798W

38 833407N  
92 881092W

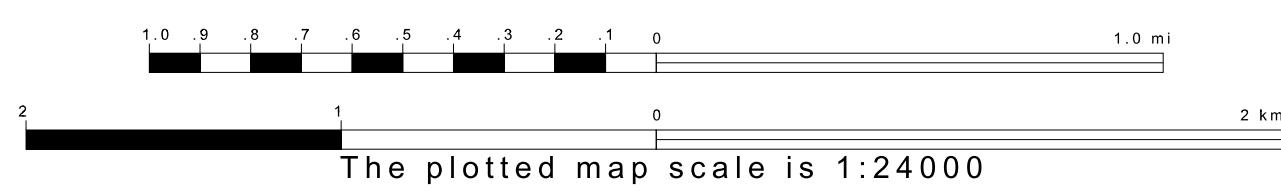
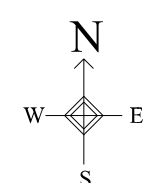

Sheet Location within County

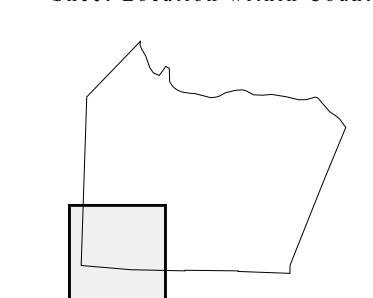

Key to Adjacent Sheets

4	5
7	8

ST: Missouri (29)  
 COU: Cooper (053)  
 SHEET 7 OF 9 PARENT SHEETS

