

P.L. 94-171 VOTING DISTRICT/STATE LEGISLATIVE DISTRICT OUTLINE MAP (CENSUS 2000)

39 942402N
94 062782W

39 942402N
94 062782W

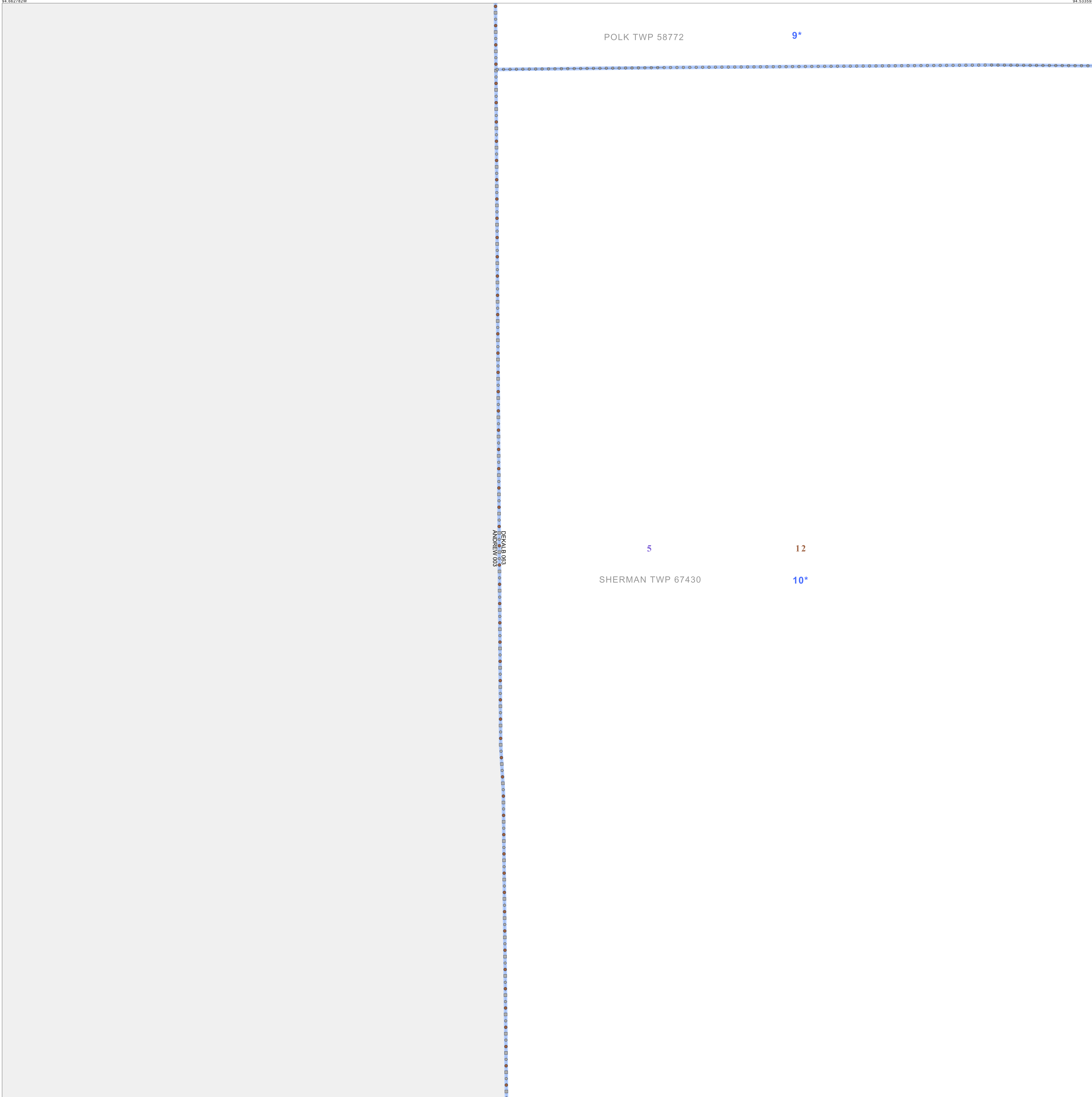

GEOGRAPHIC AREAS LEGEND

SYMBOL	NAME STYLE
*****	INTERNATIONAL
//////	STATE
□□□□	COUNTY
○●○●	MINOR CIVIL DIV. ¹
■	Incorporated Place ¹
■	Census Designated Place ¹
■	Voting District ²
●●●●	SLD-Senate
▲▲▲▲	SLD-House

Military
 Inset
 Out Area

Abbreviation Reference: AIR - American Indian Reservation; SDAISA - State Designated American Indian Statistical Area
¹ A "*" following a place name indicates that the place is coterminous with a MCD. A "-" indicates that the place is also a false MCD. In both cases, the MCD name is shown only when it differs from the place name.
² A "*" following a VTD code indicates an actual voting district. Its absence indicates that the VTD is a pseudo voting district or no information is available as to its status.

Voting Districts

Code	Name
9*	Polk Voting District
10*	Sherman Voting District

39 842880N
94 062782W

39 842880N
94 062782W

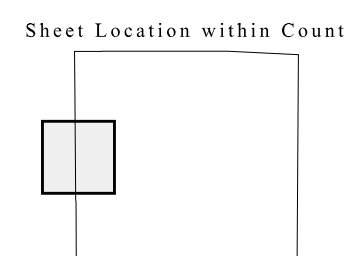
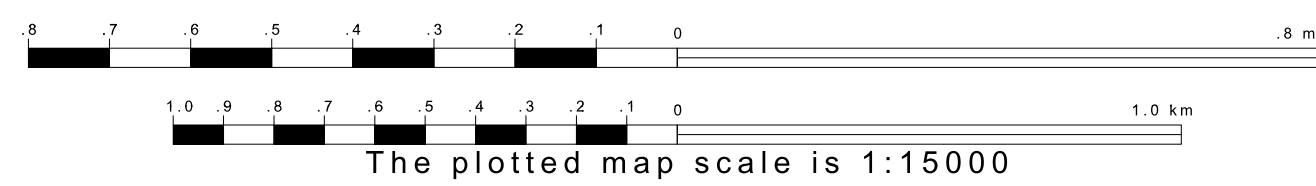

Key to Adjacent Sheets

1	2
5	6
9	10

ST: Missouri (29)
 COU: DeKalb (063)
 SHEET 5 OF 12 PARENT SHEETS

