

P. L. 94-171 COUNTY BLOCK MAP (CENSUS 2000)

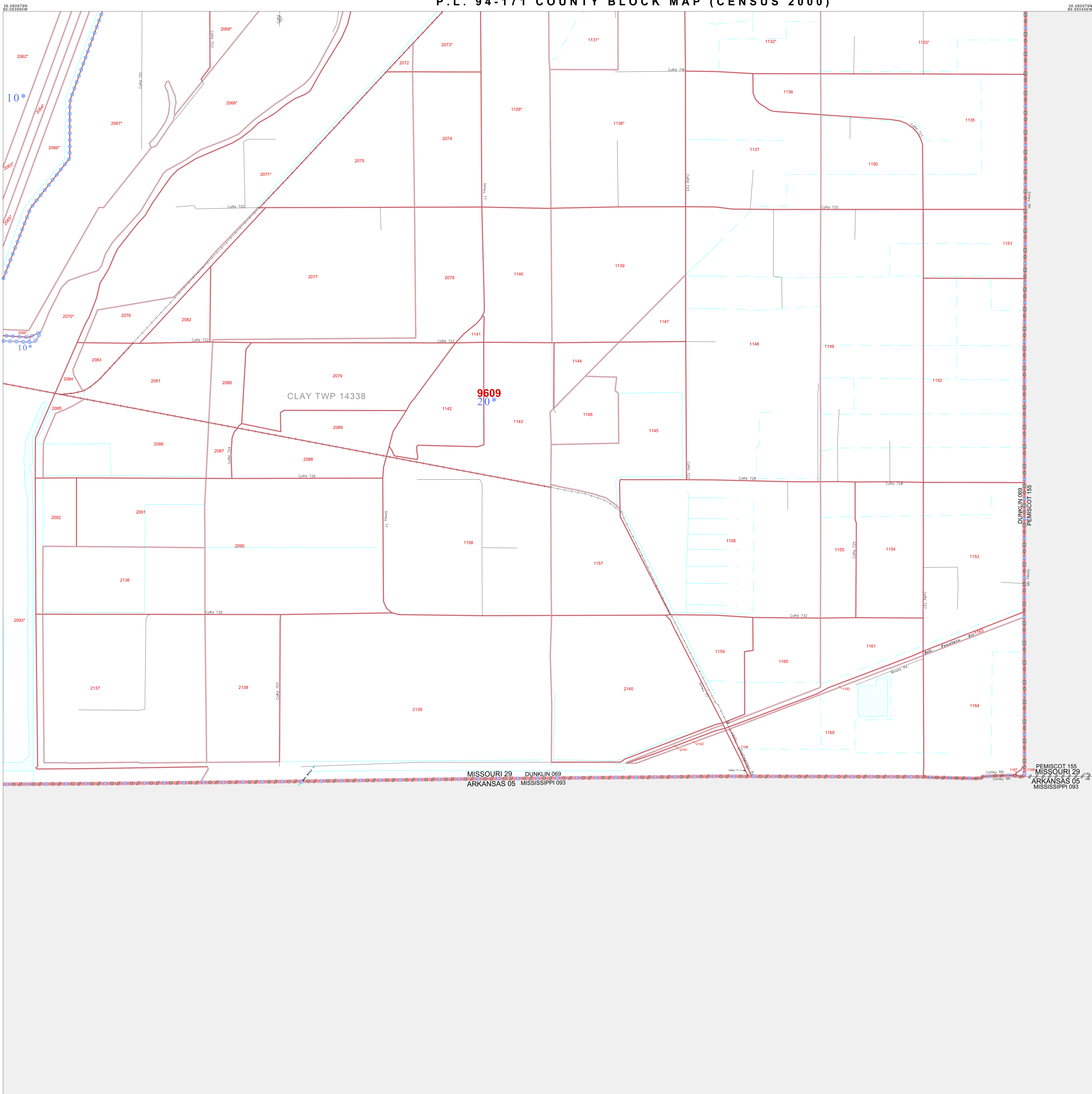

**GEOGRAPHIC AREAS LEGEND**

SYMBOL	NAME STYLE
*****	INTERNATIONAL
//////	STATE
####	COUNTY
●●●●	MINOR CIVIL DIV <sup>1</sup>
<span style="background-color: yellow; border: 1px solid black; padding: 2px;"> </span>	Incorporated Place <sup>1</sup>
<span style="background-color: lightgreen; border: 1px solid black; padding: 2px;"> </span>	Census Designated Place <sup>1</sup>
-----	Corporate Offset Boundary
●●●●	Voting District <sup>2</sup>
=====	Census Tract <sup>3</sup>
=====	BLOCK <sup>3</sup>
<span style="border: 1px dashed black; padding: 2px;"> </span>	Military
<span style="border: 1px solid black; padding: 2px;"> </span>	Inset
<span style="border: 1px solid black; padding: 2px;"> </span>	Out Area

1 A "\*" following a place name indicates that the place is coterminous with a MCD. A "-" indicates that the place is also a false MCD. In both cases, the MCD name is shown only when it differs from the place name.  
 2 A "\*" following a VTD code indicates an actual voting district. Its absence indicates that the VTD is a pseudo voting district or no information is available as to its status.  
 3 A "\*" following a block number indicates that the block number is repeated elsewhere in the block.

35 964800N  
90 093990W

The plotted map scale is 1:17500

Sheet Location within County

Key to Adjacent Sheets

10	11
13	14

35 964800N  
90 093990W