

P.L. 94-171 VOTING DISTRICT/STATE LEGISLATIVE DISTRICT OUTLINE MAP (CENSUS 2000)

39 789418N
93.661843W

39 789418N
93.511055W

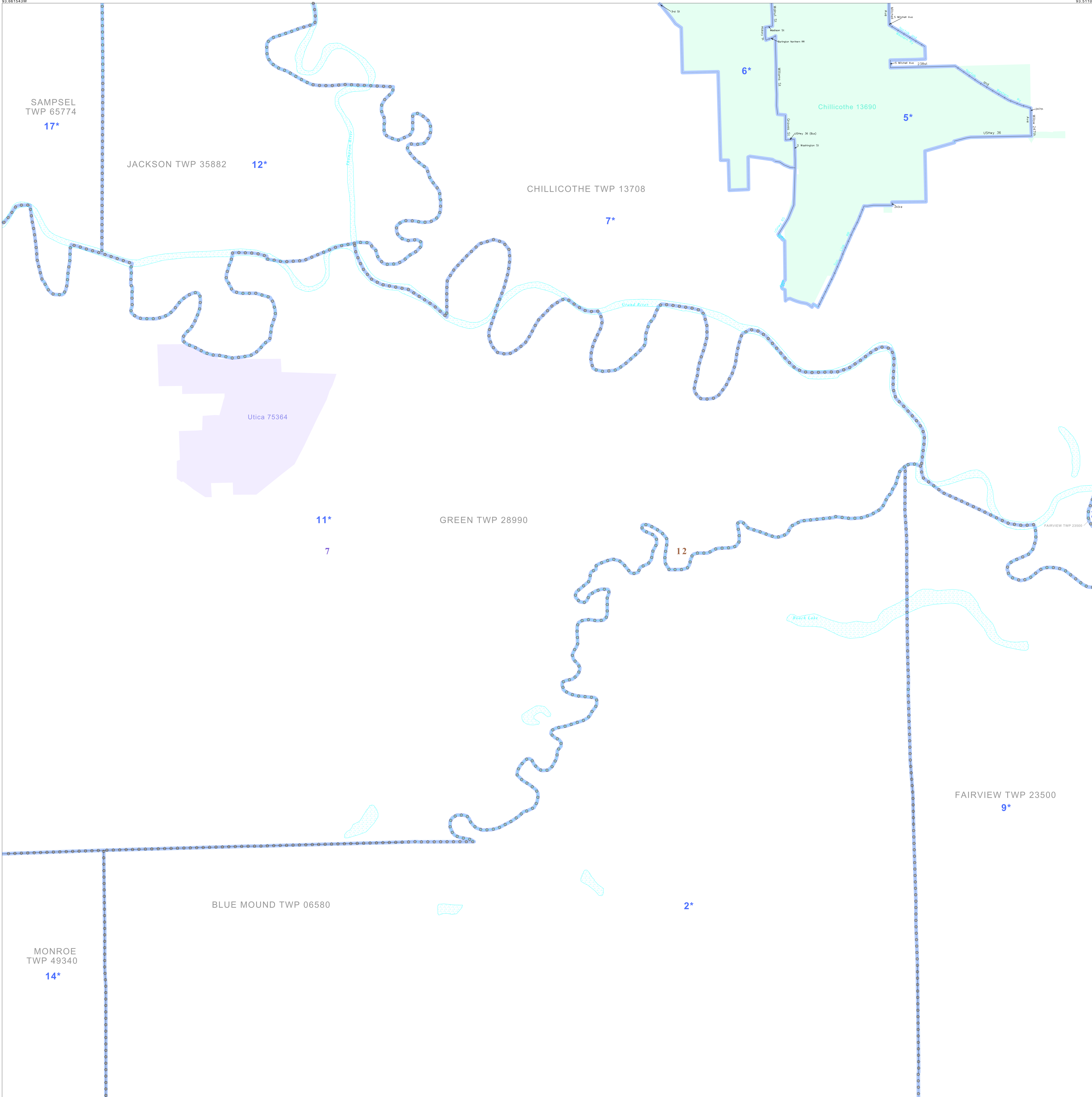

GEOGRAPHIC AREAS LEGEND

SYMBOL	NAME STYLE
*****	INTERNATIONAL
//////	STATE
□□□□	COUNTY
○ ○ ○ ○	MINOR CIVIL DIV. ¹
■ ■ ■ ■	Incorporated Place ¹
■ ■ ■ ■	Census Designated Place ²
—	Voting District
● ● ● ●	SLD—Senate
▲ ▲ ▲ ▲	SLD—House

Abbreviation Reference: AIR = American Indian Reservation; SDAISA = State Designated American Indian Statistical Area

¹ A "*" following a place name indicates that the place is coterminous with a MCD. A "*" indicates that the place is also a CMA. In both cases, the MCD name is shown only when it differs from the place name.
² A "*" following a VTD code indicates an actual voting district. Its absence indicates that the VTD is a pseudo voting district or no information is available as to its status.

Voting Districts

Code	Name
2*	BlueMound Voting District
5*	ChillicotheCityWard3
5*	ChillicotheCityWard4
7*	ChillicotheVoting District
9*	Fairview Voting District
11*	Green Voting District
12*	Jackson Voting District
14*	Monroe Voting District
17*	Sampsel Voting District

39 873317N
93.661843W

39 873317N
93.511055W

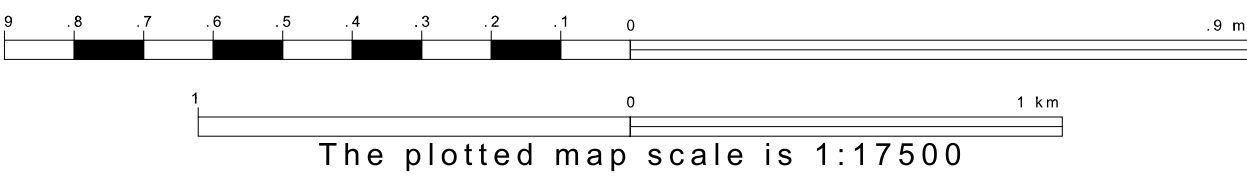
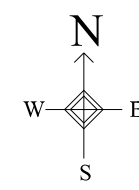

Sheet Location within County

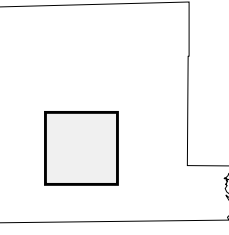

Key to Adjacent Sheets

4	5	6
7	8	9
11	12	13

ST: Missouri (29)
 COU: Livingston (117)
 SHEET 8 OF 14 PARENT SHEETS



All legal boundaries and names are as of January 1, 2000. The boundaries shown on this map are for Census Bureau statistical data collection and tabulation purposes only; their depiction and designation for statistical purposes does not constitute a determination of jurisdictional authority or rights of ownership or entitlement. U.S. DEPARTMENT OF COMMERCE Economics and Statistics Administration U.S. Census Bureau