

P. L. 94-171 COUNTY BLOCK MAP (CENSUS 2000)

GEOGRAPHIC AREAS LEGEND

| SYMBOL | NAME STYLE |
|---------|--------------------------------------|
| ***** | INTERNATIONAL |
| ////// | STATE |
| □□□□ | COUNTY |
| □□□□ | MINOR CIVIL DIV. |
| ■ ■ ■ ■ | Incorporated Place ¹ |
| ■ ■ ■ ■ | Census Designated Place ² |
| | Corporate Offset Boundary |
| ●●●● | Voting District ³ |
| ■■■■ | Census Tract |
| ■■■■ | BLOCK ³ |

Military Inset Out Area

¹ A "*" following a place name indicates that the place is coterminous with a MCD. A "-" indicates that the place is also a false MCD. In both cases, the MCD name is shown only when it differs from the place name.
² A "*" following a VTD code indicates an actual voting district. Its absence indicates that the VTD is a pseudo voting district or no information is available as to its status.
³ A "-" following a block number indicates that the block number is repeated elsewhere in the block.

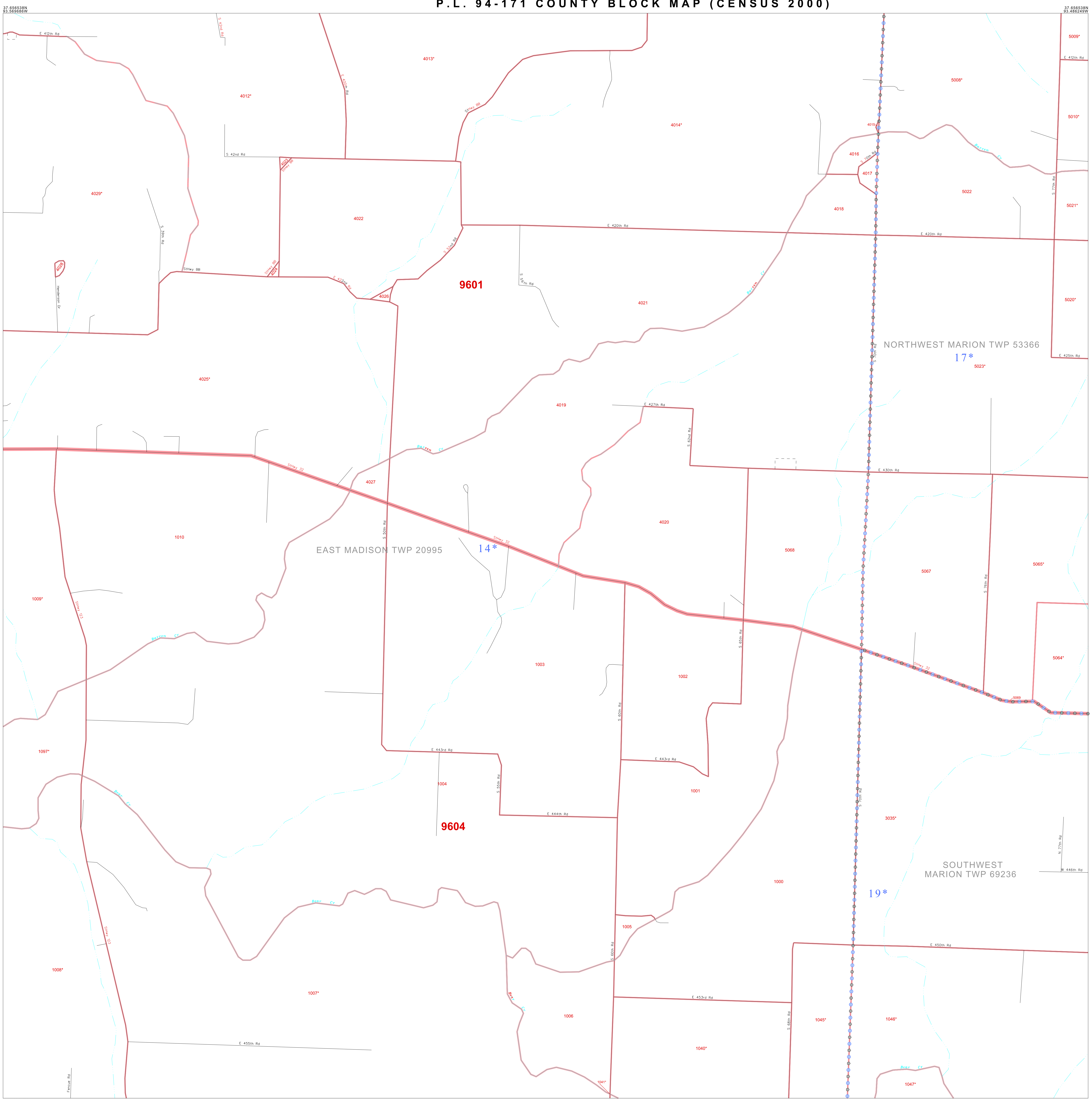

37 556170N
93 569866W
37 556170N
93 486249W

N
W E S
Sheet Location within County

0 1 2 3 4 5 6 7 8 9 10 11 12 13 14 15 16 17 18 19 20 21 22 23 24 25 26 27 28 29 30 31 32 33 34 35 36 37 38 39 40 41 42 43 44 45 46 47 48 49 50 51 52 53 54 55 56 57 58 59 60 61 62 63 64 65 66 67 68 69 70 71 72 73 74 75 76 77 78 79 80 81 82 83 84 85 86 87 88 89 90 91 92 93 94 95 96 97 98 99 100
Key to Adjacent Sheets

0 1 2 3 4 5 6 7 8 9 10 11 12 13 14 15 16 17 18 19 20 21 22 23 24 25 26 27 28 29 30 31 32 33 34 35 36 37 38 39 40 41 42 43 44 45 46 47 48 49 50 51 52 53 54 55 56 57 58 59 60 61 62 63 64 65 66 67 68 69 70 71 72 73 74 75 76 77 78 79 80 81 82 83 84 85 86 87 88 89 90 91 92 93 94 95 96 97 98 99 100
13 14 15
19 20 21
25 26 27

The plotted map scale is 1:10000
ST: Missouri (29)
COU: Polk (167)
SHEET 20 OF 42 PARENT SHEETS