

P.L. 94-171 VOTING DISTRICT/STATE LEGISLATIVE DISTRICT OUTLINE MAP (CENSUS 2000)

36 980008N
89 467040W

36 980008N
89 301415W

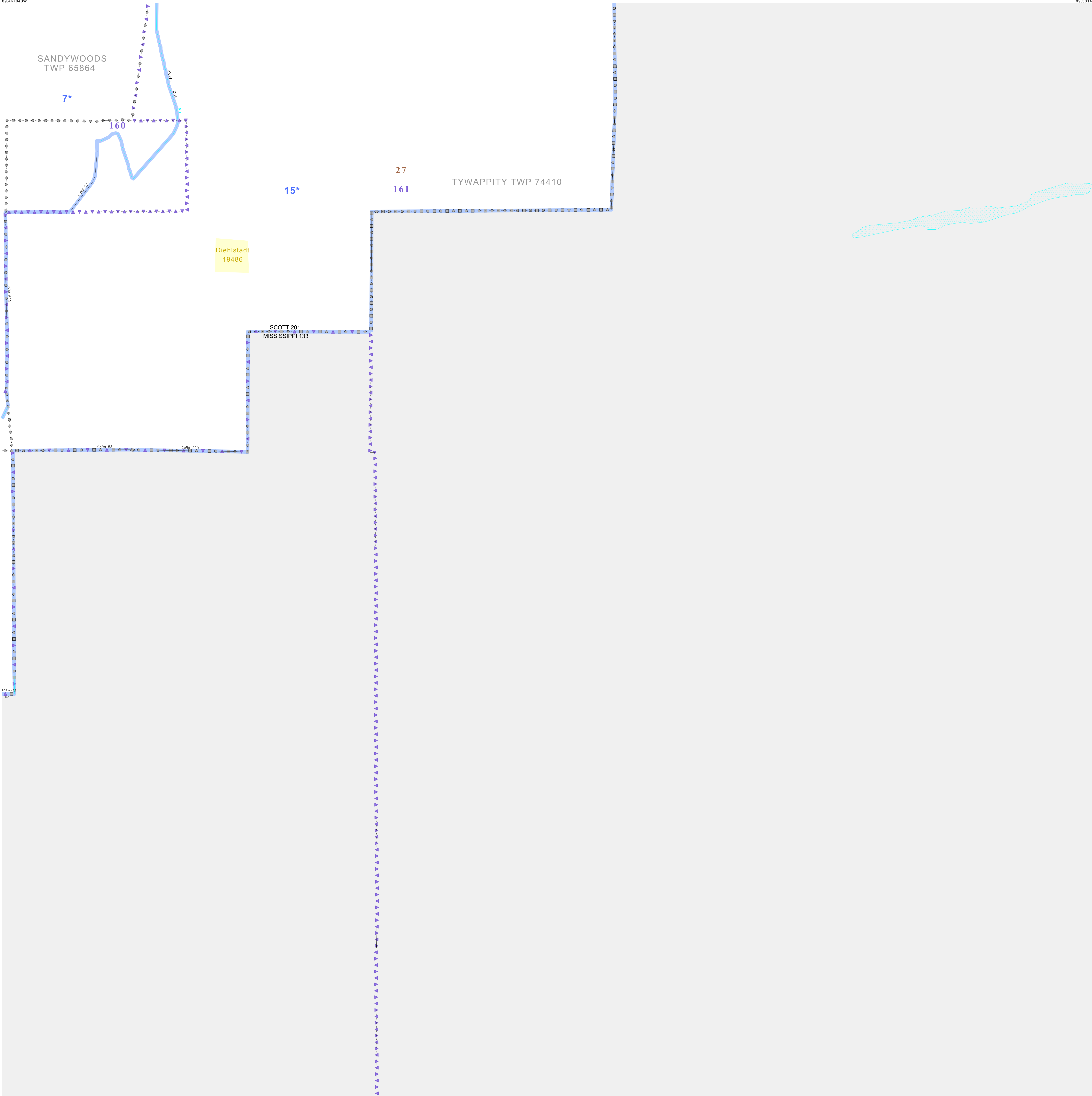

GEOGRAPHIC AREAS LEGEND

SYMBOL	NAME STYLE
*****	INTERNATIONAL
//////	STATE
-----	COUNTY
.....	MINOR CIVIL DIV. ¹
Yellow box	Incorporated Place ¹
Orange box	Census Designated Place ²
Blue line	Voting District
Brown line	SLD-Senate
Purple line	SLD-House

Boundary Inset Out Area

Abbreviation Reference: AIR - American Indian Reservation; SDAISA - State Designated American Indian Statistical Area

¹ A "*" following a place name indicates that the place is coterminous with a MCD. A "-" indicates that the place is also a false MCD. In both cases, the MCD name is shown only when it differs from the place name.
² A "*" following a VTD code indicates an actual voting district. Its absence indicates that the VTD is a pseudo voting district or no information is available as to its status.

Voting Districts

Code	Name
7*	Blodgett Voting District
15*	Diehlstadt Voting District

36 857260N
89 467040W

36 857260N
89 301415W

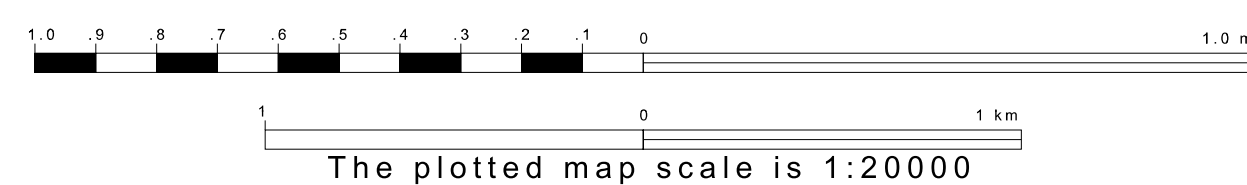
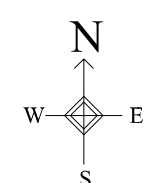

Sheet Location within County

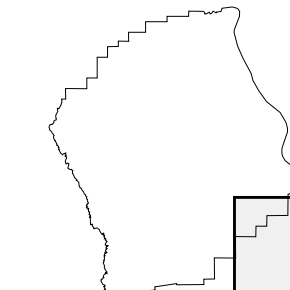

Key to Adjacent Sheets

5	6
8	9

ST: Missouri (29)
 COU: Scott (201)
 SHEET 9 OF 9 PARENT SHEETS

