

P.L. 94-171 VOTING DISTRICT/STATE LEGISLATIVE DISTRICT OUTLINE MAP (CENSUS 2000)

37 779127N  
90 278163W

37 779127N  
90 077878W

**GEOGRAPHIC AREAS LEGEND**

SYMBOL	NAME STYLE
*****	INTERNATIONAL
//////	STATE
□□□□□□	COUNTY
○ ○ ○ ○ ○	MINOR CIVIL DIV <sup>1</sup>
■ ■ ■ ■ ■	Incorporated Place <sup>1</sup>
■ ■ ■ ■ ■	Census Designated Place <sup>2</sup>
▬▬▬▬▬	Voting District
●●●●●	SLD-Senate
▲▲▲▲▲	SLD-House
□□□□□	Boundary
□□□□□	Inset
□□□□□	Out Area

Abbreviation Reference: AIR - American Indian Reservation; SDAISA - State Designated American Indian Statistical Area

<sup>1</sup> A " " following a place name indicates that the place is coterminous with a MCD. A " " indicates that the place is also a false MCD. In both cases, the MCD name is shown only when it differs from the place name.

<sup>2</sup> A " " following a VTD code indicates an actual voting district. Its absence indicates that the VTD is a pseudo voting district or no information is available as to its status.

**Voting Districts**

Code	Name
22*	Libertyville Voting District

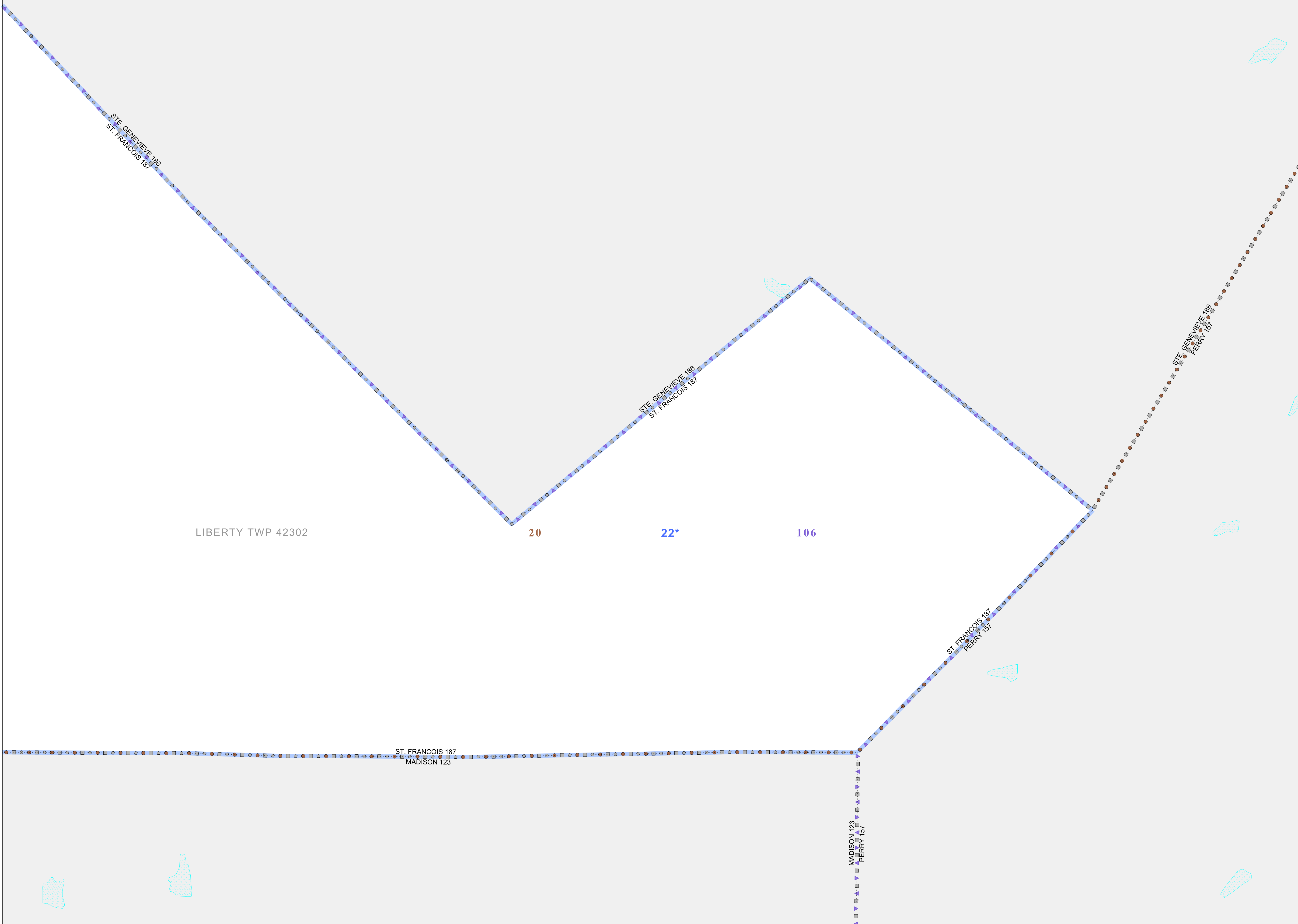

37 619850N  
90 278163W

37 619850N  
90 077878W

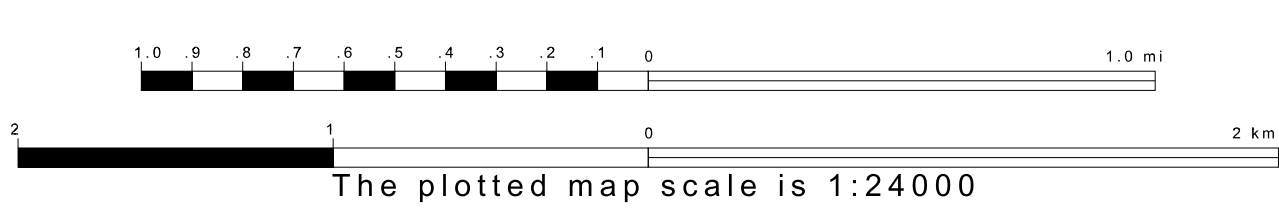

Sheet Location within County

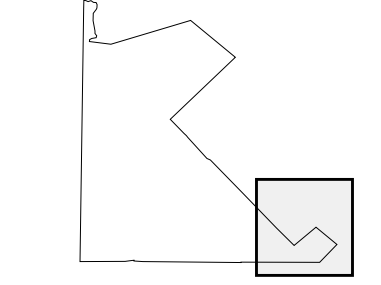

Key to Adjacent Sheets

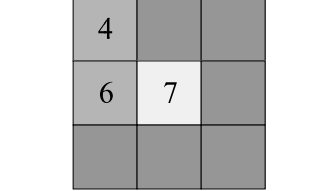

ST: Missouri (29)  
COU: St. Francois (187)  
SHEET 7 OF 7 PARENT SHEETS