

P.L. 94-171 VOTING DISTRICT/STATE LEGISLATIVE DISTRICT OUTLINE MAP (CENSUS 2000)

37 509549N
92 292190W

37 509549N
92 084241W

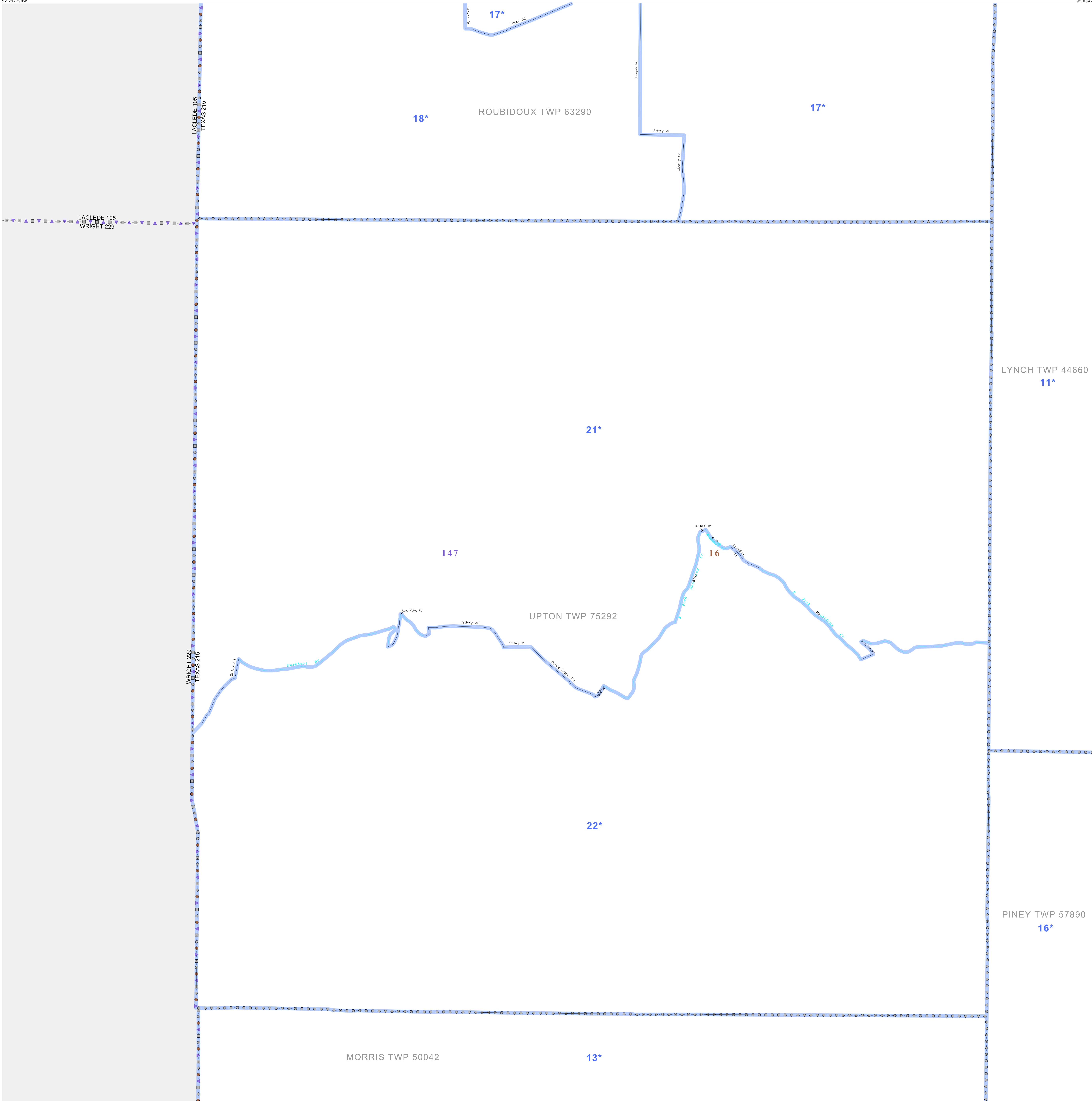

GEOGRAPHIC AREAS LEGEND

SYMBOL	NAME STYLE
*****	INTERNATIONAL
//////	STATE
□□□□□□	COUNTY
○●○●○●	MINOR CIVIL DIV. ¹
■	Incorporated Place ¹
■	Census Designated Place ²
—	Voting District
●●●●●●	SLD-Senate
▲▲▲▲▲▲	SLD-House

Abbreviation Reference: AIR - American Indian Reservation; SDAISA - State Designated American Indian Statistical Area

1 A * * following a place name indicates that the place is coterminous with a MCD. A * * indicates that the place is also a MCD. In both cases, the MCD name is shown only when it differs from the place name.

2 A * * following a VTD code indicates an actual voting district. Its absence indicates that the VTD is a pseudo voting district or no information is available as to its status.

Voting Districts

Code	Name
11*	LynchWard1
13*	Morris Voting District
147	Piney Voting District
16*	RoubidouxWard1
17*	RoubidouxWard2
21*	UptonWard1
22*	UptonWard2

37 327027N
92 292190W

37 327027N
92 084241W

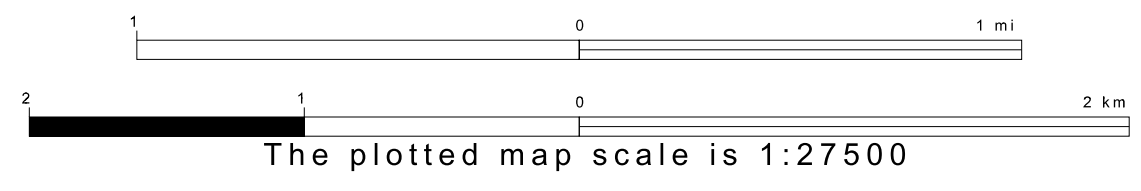
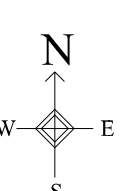

Sheet Location within County

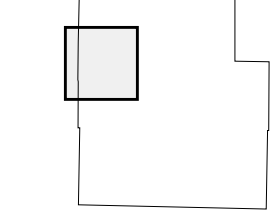

Key to Adjacent Sheets

1	2
4	5
7	8

ST: Missouri (29)
COU: Texas (215)
SHEET 4 OF 12 PARENT SHEETS

