

P.L. 94-171 VOTING DISTRICT/STATE LEGISLATIVE DISTRICT OUTLINE MAP (CENSUS 2000)

37 383398N
92 850546W

37 383398N
92 809202W

GEOGRAPHIC AREAS LEGEND

SYMBOL	NAME STYLE
*****	INTERNATIONAL
//////	STATE
■■■■■	COUNTY
○○○○○	MINOR CIVIL DIV ¹
■ ■ ■ ■ ■	Incorporated Place ¹
■ ■ ■ ■ ■	Census Designated Place ¹
———	Voting District ²
●●●●●	SLD-Senate
▲▲▲▲▲	SLD-House

Military
 Inset
 Out Area

Abbreviation Reference: AIR = American Indian Reservation; SDAISA = State Designated American Indian Statistical Area

¹ A "*" following a place name indicates that the place is coterminous with a MCD. A "-" indicates that the place is also a MCD. In both cases, the MCD name is shown only when it differs from the place name.

² A "*" following a VTD code indicates an actual voting district. Its absence indicates that the VTD is a pseudo voting district or no information is available as to its status.

Voting Districts

Code	Name
4*	DallasEast Voting District
10*	HighPrairie Voting District
12*	Niangua Voting District
13*	OzarkEast Voting District
14*	OzarkWest Voting District

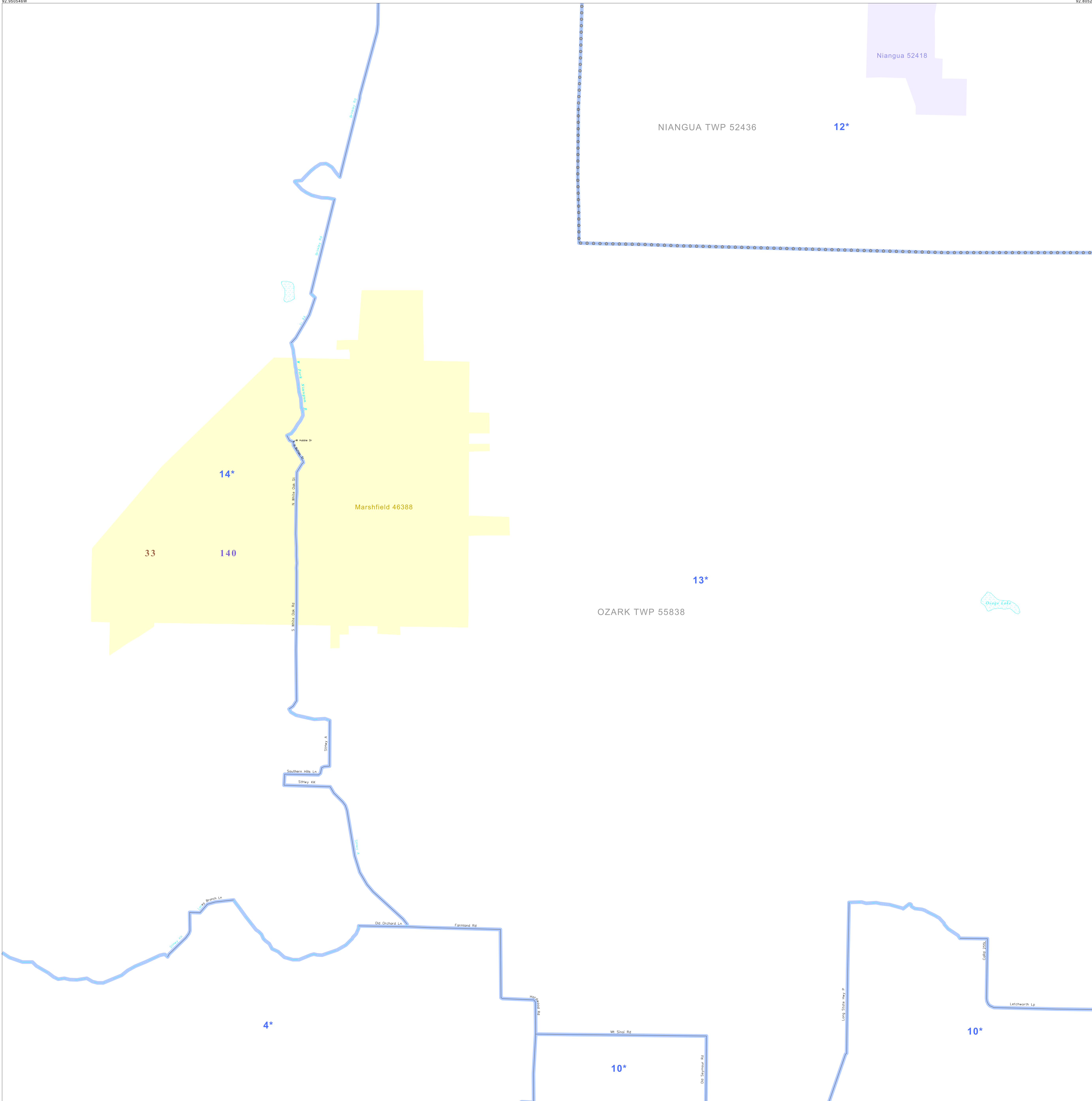

37 277248N
92 850546W

37 277248N
92 809202W

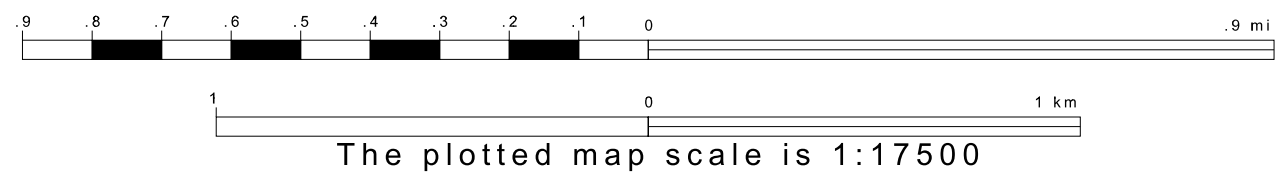

Sheet Location within County

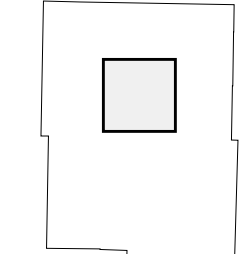

Key to Adjacent Sheets

1	2	3
4	5	6
7	8	9

ST: Missouri (29)
 COU: Webster (225)
 SHEET 5 OF 12 PARENT SHEETS

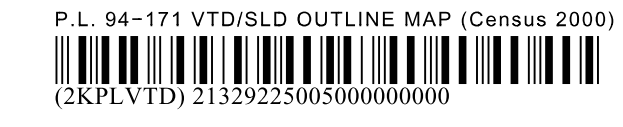

All legal boundaries and names are as of January 1, 2000. The boundaries shown on this map are for Census Bureau statistical data collection and tabulation purposes only; their depiction and designation for statistical purposes does not constitute a determination of jurisdictional authority or rights of ownership or entitlement. U.S. DEPARTMENT OF COMMERCE Economics and Statistics Administration U.S. Census Bureau