

P.L. 94-171 VOTING DISTRICT/STATE LEGISLATIVE DISTRICT OUTLINE MAP (CENSUS 2000)

36 954213N  
94.122295W

36 954213N  
93.834949W

### GEOGRAPHIC AREAS LEGEND

| SYMBOL  | NAME STYLE                           |
|---------|--------------------------------------|
| *****   | INTERNATIONAL                        |
| //////  | STATE                                |
| □□□□    | COUNTY                               |
| ○ ○ ○ ○ | MINOR CIVIL DIV <sup>1</sup>         |
| ■ ■ ■ ■ | Incorporated Place <sup>1</sup>      |
| ■ ■ ■ ■ | Census Designated Place <sup>2</sup> |
| ▬▬▬▬    | Voting District                      |
| ●●●●    | SLD-Senate                           |
| ▲▲▲▲    | SLD-House                            |

Abbreviation Reference: AIR = American Indian Reservation; SDAISA = State Designated American Indian Statistical Area

<sup>1</sup> A "\*" following a place name indicates that the place is coterminous with a MCD. A "\*" indicates that the place is also a false MCD. In both cases, the MCD name is shown only when it differs from the place name.

<sup>2</sup> A "\*" following a VTD code indicates an actual voting district. Its absence indicates that the VTD is a pseudo voting district or no information is available as to its status.

### Voting Districts

| Code | Name                           |
|------|--------------------------------|
| 3*   | Butterfield Voting District    |
| 4*   | CappsCreek Voting District     |
| 5*   | Easton Voting District         |
| 6*   | FlatCreek/W Voting District    |
| 10*  | KingsPrairie Voting District   |
| 11*  | Monett/W44/W46 Voting District |
| 14*  | PleasantRidge Voting District  |
| 15*  | Purdy Voting District          |
| 20*  | Wheaton Voting District        |

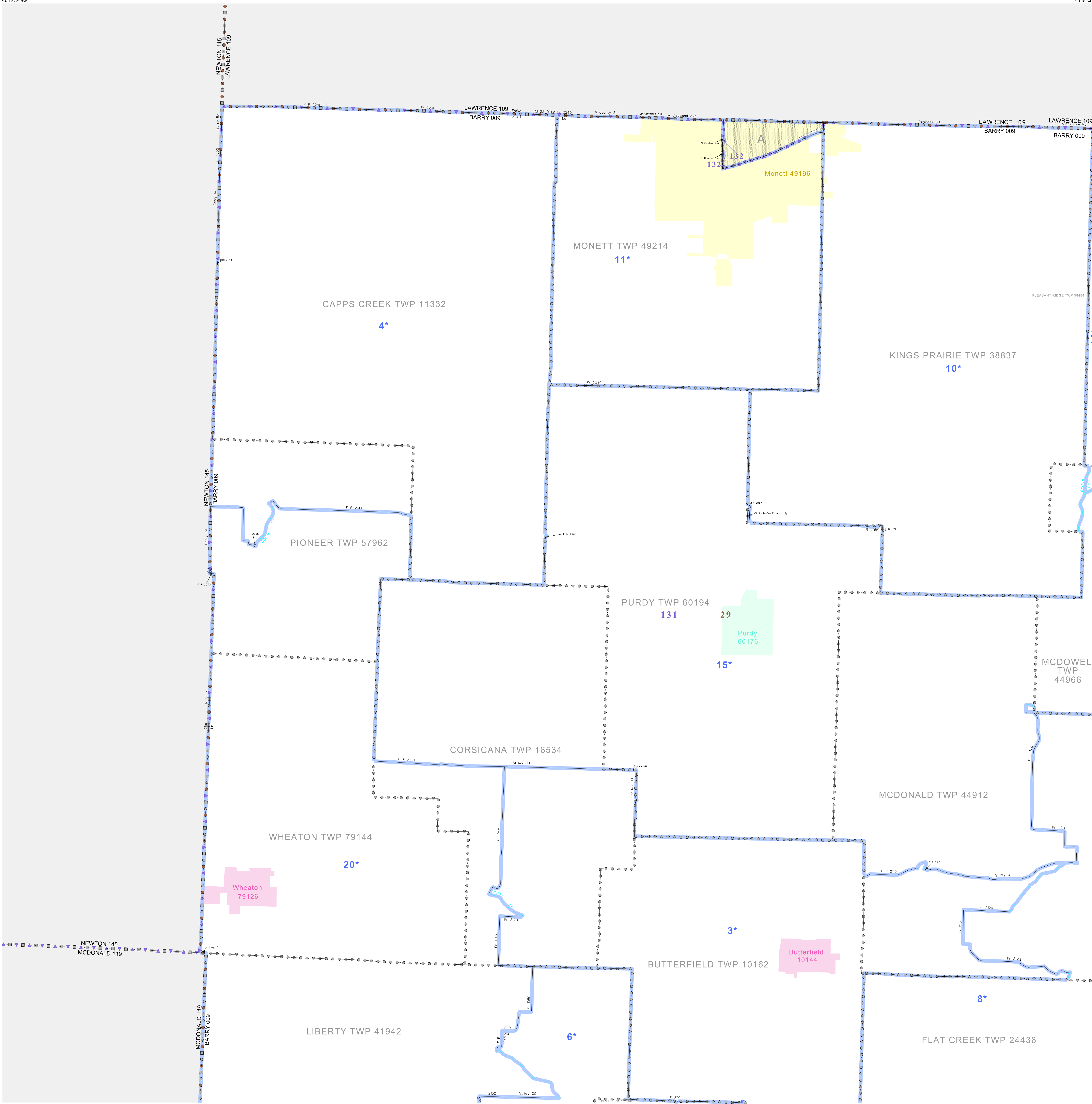

36 715250N  
94.122295W

36 715250N  
93.834949W

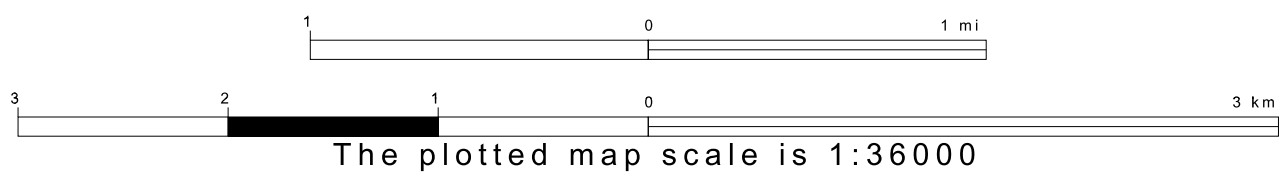

Sheet Location within County

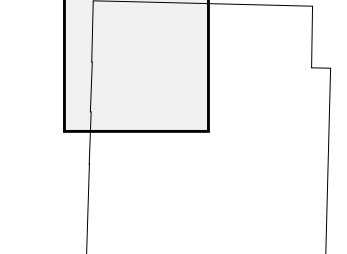

Key to Adjacent Sheets

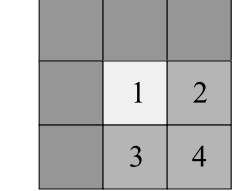

ST: Missouri (29)  
COU: Barry (009)  
SHEET 1 OF 4 PARENT SHEETS

