

INDEX FOR P.L. 94-171 COUNTY BLOCK MAP (CENSUS 2000)

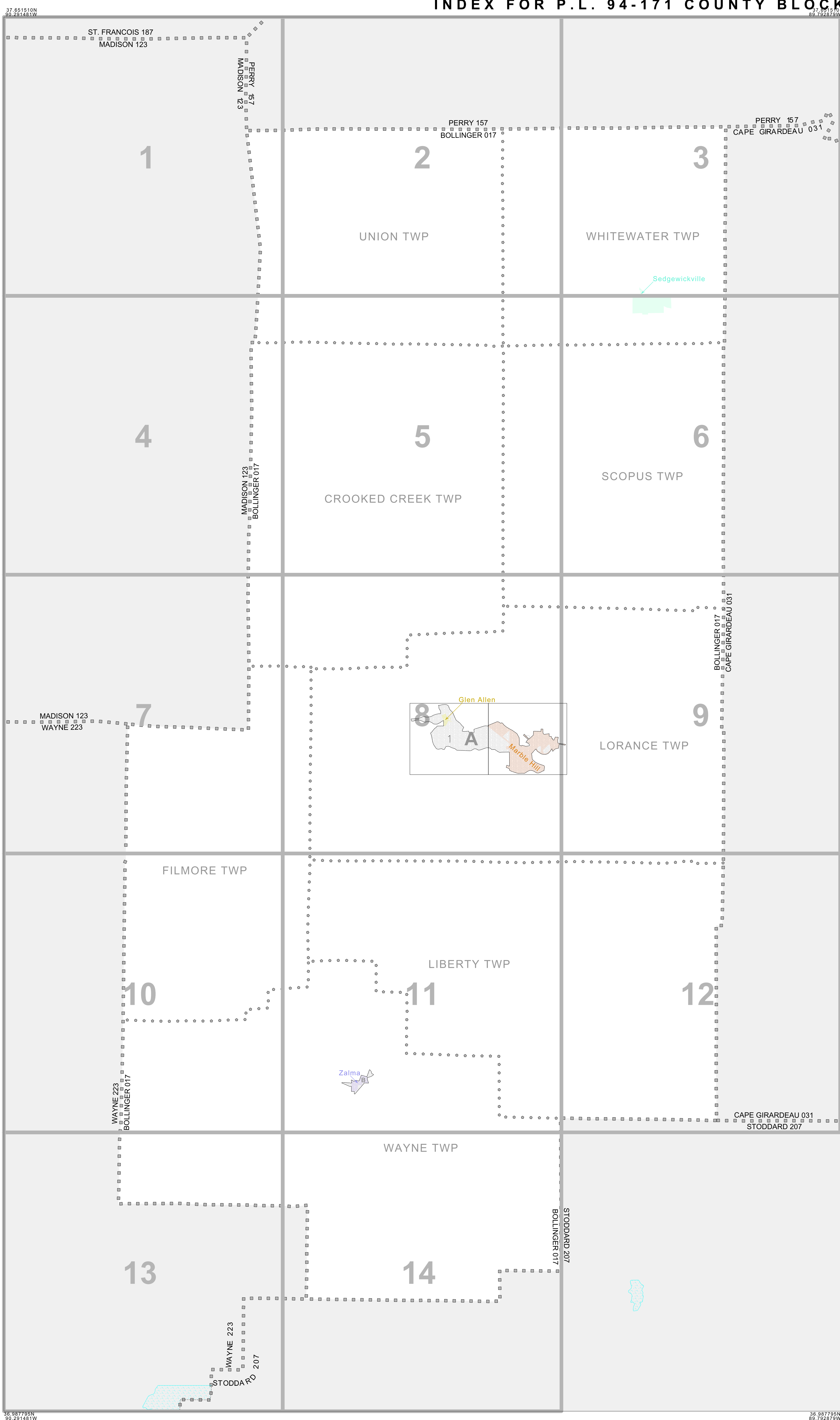

INDEX MAP LEGEND

SYMBOL	NAME STYLE
*****	INTERNATIONAL
-----	AIR (FEDERAL)
-----	Trust Land/HLL
-----	OTSA/ANVSA/TDSA
-----	TRIBAL SUBDIVISION
-----	AIR (State)
-----	SDA/ISA
-----	ANRC
#####	STATE
####	COUNTY
o-o-o-o-o	MINOR CIVIL DIV.¹
o-o-o-o-o	Consolidated City
o-o-o-o-o	Incorporated Place¹
o-o-o-o-o	Census Designated Place¹

Inset Out Area

Abbreviation Reference: AIR = American Indian Reservation; Trust Land = Off-Reservation Trust Land; ANRC = Alaska Native Regional Corporation; OTSA = Oklahoma Tribal Statistical Area; Tribal Designated Statistical Area; American Indian Tribal Subdivision; American Indian Reservation (State); State Designated American Indian Statistical Area; Alaska Native Regional Corporation; State or Statistically Equivalent Entity; County or Statistically Equivalent Entity; Minor Civil Division (MCD)¹; Census County Division (CCD); Consolidated City; Incorporated Place¹; Census Designated Place (CDP)¹; Corporate Offset Boundary; Voting District (VTD)²; Census Tract; Block³

P.L. 94-171 COUNTY BLOCK MAP LEGEND (CENSUS 2000)

SYMBOL DESCRIPTION	SYMBOL	NAME STYLE
International	*****	CANADA
American Indian Reservation (Federal)	*****	L'ANSE RES (1880)
Off-Reservation Trust Land, Hawaiian Home Land	*****	T1880
Oklahoma Tribal Statistical Area, Alaska Native Village Statistical Area, Tribal Designated Statistical Area	o-o-o-o-o	KAW OTSA (5340)
American Indian Tribal Subdivision	o-o-o-o-o	SHONTO (620)
American Indian Reservation (State)	o-o-o-o-o	Tama Res (4125)
State Designated American Indian Statistical Area	o-o-o-o-o	Lumbee (9815)
Alaska Native Regional Corporation	o-o-o-o-o	NANA ANRC 52120
State or Statistically Equivalent Entity	#####	NEW YORK 36
County or Statistically Equivalent Entity	####	ERIE 029
Minor Civil Division (MCD)¹	o-o-o-o-o	PIKE TWP 59742
Census County Division (CCD)	o-o-o-o-o	KULA CCD 91890
Consolidated City	o-o-o-o-o	Milford 47500
Incorporated Place¹	o-o-o-o-o	Rome 63418
Census Designated Place (CDP)¹	o-o-o-o-o	Zena 84187
Corporate Offset Boundary	-----	
Voting District (VTD)²	o-o-o-o-o	023*
Census Tract	o-o-o-o-o	5702.01
Block³	o-o-o-o-o	1320

FEATURE	SYMBOL	FEATURE	SYMBOL
Interstate or Other Highway	-----	Perennial Stream or Shoreline	-----
Secondary Road	-----	Intermittent Stream or Shoreline	-----
Leop Trail, Walkway, Stairway, or Ferry	-----	Large River or Lake	-----
Railroad	-----	Glacier	-----
Pipelng or Power Line	-----	Military Installation	-----
Ridge, Fence, or Other Physical Feature	-----	Inset Area	-----
Property Line or Fence Line	-----	Outside Subject Area	-----
Nonvisible Boundary or Feature Not Elsewhere Classified	-----		

Where international, state, and/or county boundaries coincide, the map shows the boundary symbol for only the highest-ranking of these boundaries.
 1 A " " following a place name indicates that the place is coterminous with a MCD. A " " following an incorporated place name indicates that the place is also a false MCD. In both cases, the MCD name is shown only when it differs from the place name.
 2 A " " following a VTD code indicates an actual voting district. Its absence indicates that the VTD is a pseudo voting district or no information is available as to its status.
 3 A " " following a block number indicates that the block number is repeated elsewhere in the block.

