

P.L. 94-171 VOTING DISTRICT/STATE LEGISLATIVE DISTRICT OUTLINE MAP (CENSUS 2000)

37 160361N
90 241820W

37 160361N
90 241820W

LIBERTY 6*

GEOGRAPHIC AREAS LEGEND

SYMBOL	NAME STYLE
*****	INTERNATIONAL
//////	STATE
□□□□	COUNTY
○○○○	MINOR CIVIL DIV ¹
■ ■ ■ ■	Incorporated Place ¹
■ ■ ■ ■	Census Designated Place ²
▬	Voting District
● ● ● ●	SLD-Senate
▲ ▲ ▲ ▲	SLD-House

Abbreviation Reference: AIR - American Indian Reservation; SDAISA - State Designated American Indian Statistical Area

¹ A "*" following a place name indicates that the place is coterminous with a MCD. A "-" indicates that the place is also a MCD. In both cases, the MCD name is shown only when it differs from the place name.
² A "*" following a VTD code indicates an actual voting district. Its absence indicates that the VTD is a pseudo voting district or no information is available as to its status.

Voting Districts

Code	Name
6*	Lutesville Voting District
15*	Zalma Voting District

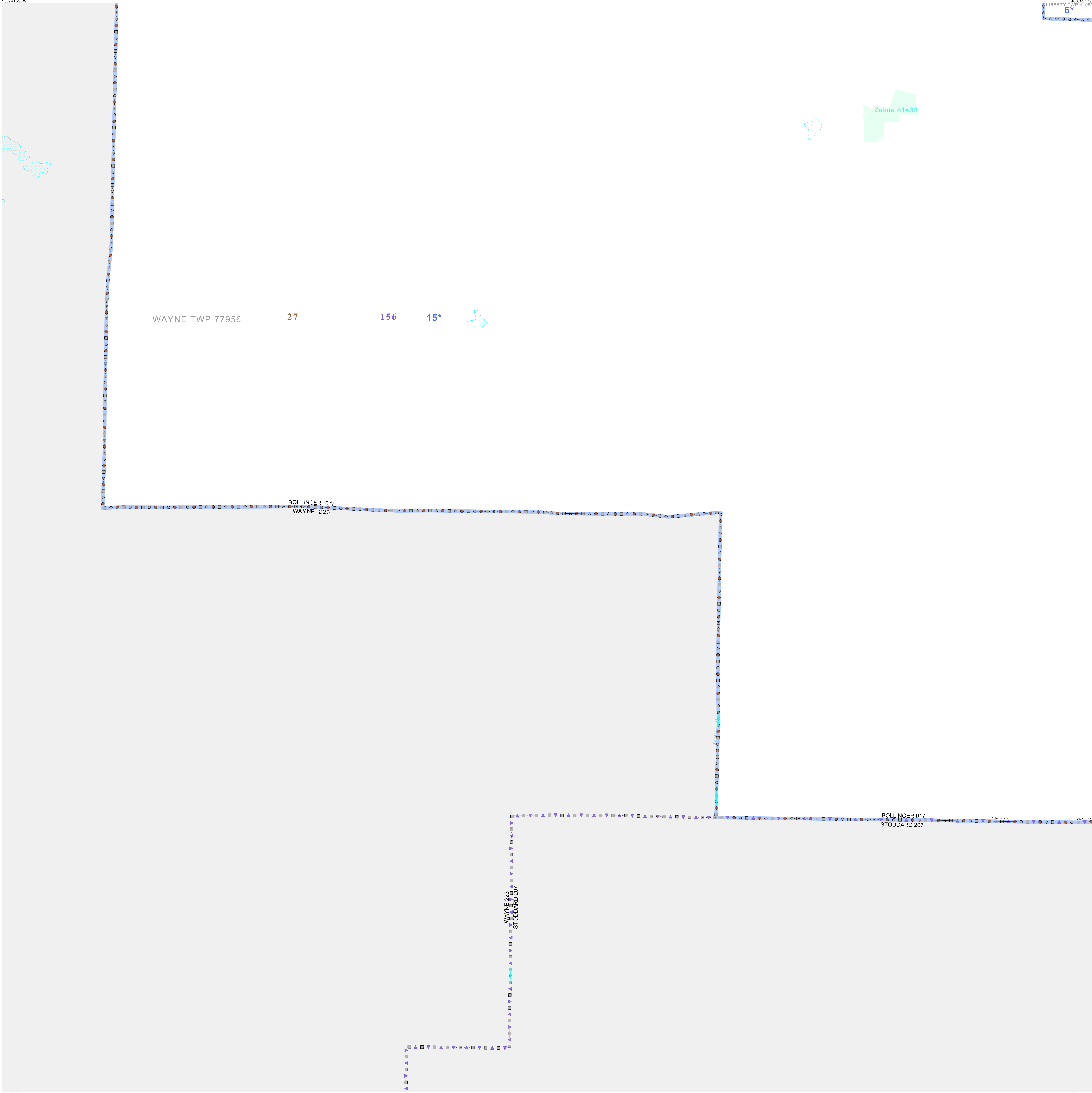

37 051070N
90 241820W

37 051070N
90 241820W

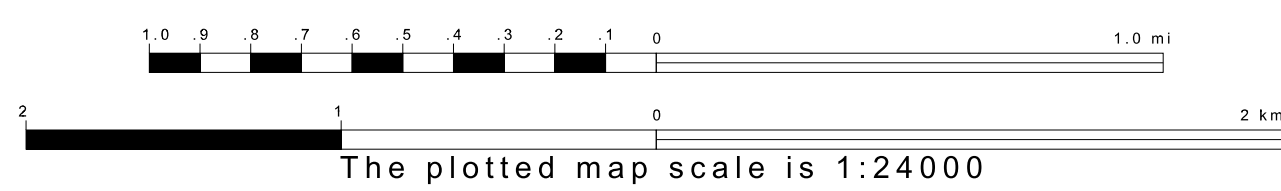
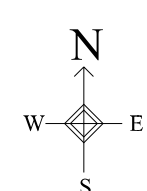

Sheet Location within County

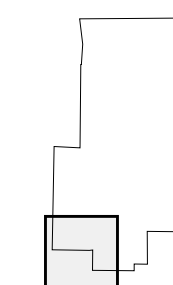

Key to Adjacent Sheets

5	6
7	8

ST: Missouri (29)
 COU: Bollinger (017)
 SHEET 7 OF 8 PARENT SHEETS