

P.L. 94-171 VOTING DISTRICT/STATE LEGISLATIVE DISTRICT OUTLINE MAP (CENSUS 2000)

37 077533N
90.860443W

37 077533N
90.407013W

GEOGRAPHIC AREAS LEGEND

SYMBOL	NAME STYLE
*****	INTERNATIONAL
//////	STATE
■■■■■■	COUNTY
○○○○○○	MINOR CIVIL DIV. ¹
■■■■■■	Incorporated Place ¹
■■■■■■	Census Designated Place ²
■■■■■■	Voting District
●●●●●●	SLD-Senate
▲▲▲▲▲▲	SLD-House
.....	Minority
Inset	Inset
Out Area	Out Area

Abbreviation Reference: AIR - American Indian Reservation; SDAISA - State Designated American Indian Statistical Area

¹ A * following a place name indicates that the place is coextensive with a MCD. A ** indicates that the place is also a false MCD. In both cases, the MCD name is shown only when it differs from the place name.

² A * following a VTD code indicates an actual voting district. Its absence indicates that the VTD is a pseudo voting district or no information is available as to its status.

Voting Districts

Code	Name
3*	CaneCreek Voting District
7*	Handrickson Voting District
8*	Hillview Voting District
9*	Koyue Voting District
10*	Lakeland Voting District
11*	Moark Voting District
13*	OakBluff Voting District
14*	OakGreen Voting District
23*	Salisbury Voting District
24*	IronSprings Voting District
25*	WaltonChapel Voting District

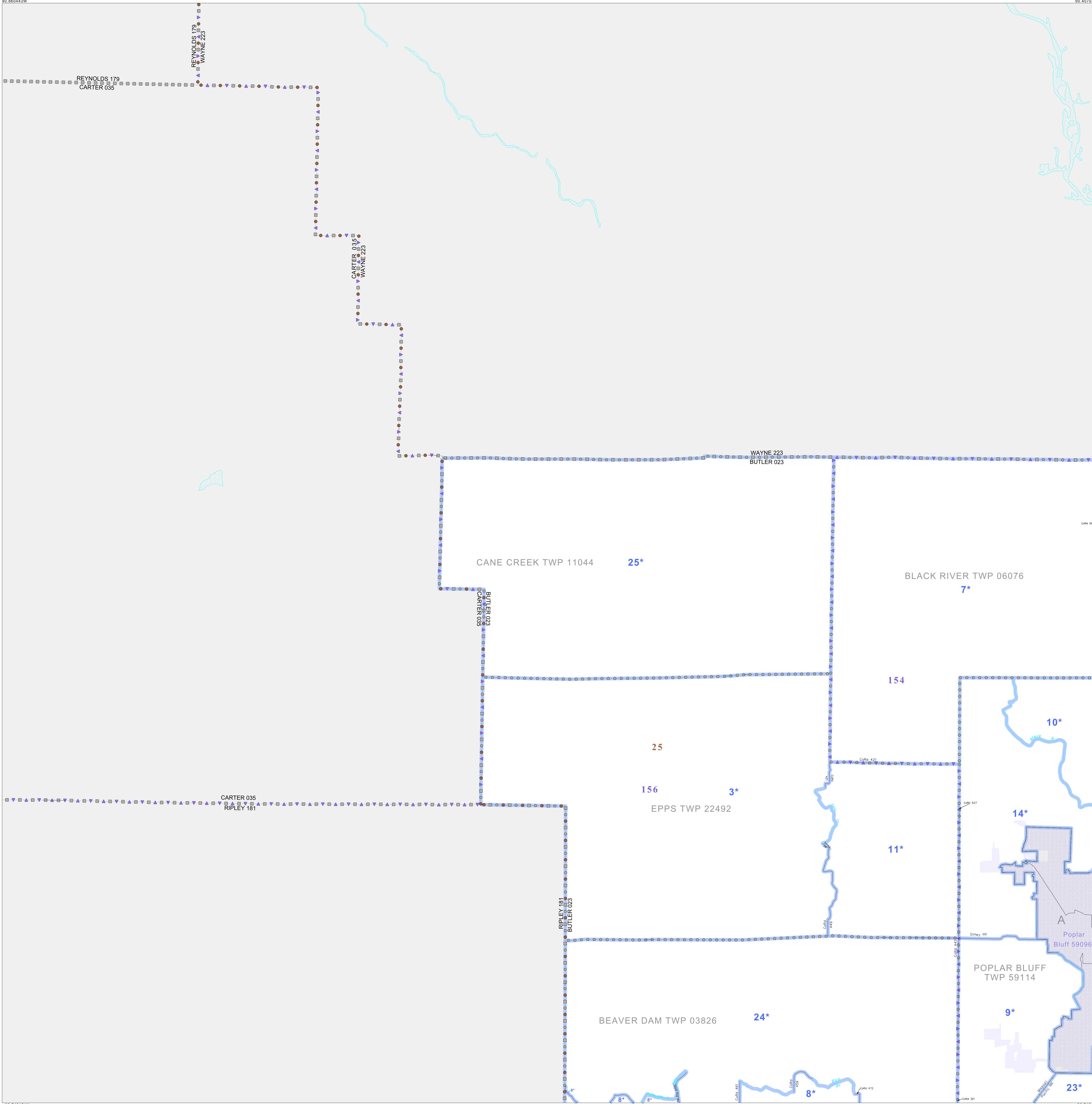

36.712451N
90.860443W

36.712451N
90.407013W

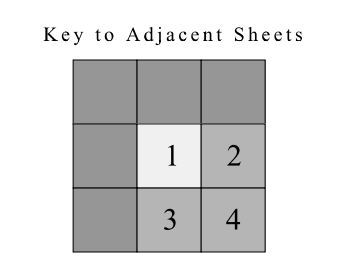
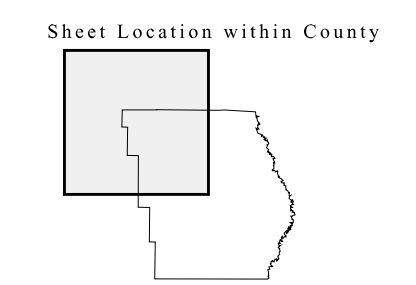
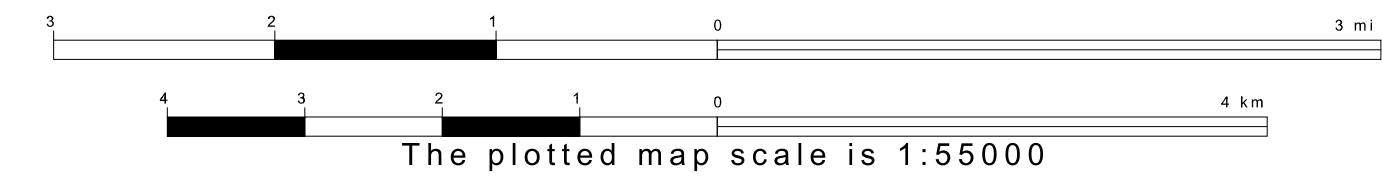

ST: Missouri (29)
COU: Butler (023)
SHEET 1 OF 4 PARENT SHEETS

All legal boundaries and names are as of January 1, 2000. The boundaries shown on this map are for Census Bureau statistical data collection and tabulation purposes only; their depiction and designation for statistical purposes does not constitute a determination of jurisdictional authority or rights of ownership or entitlement. U.S. DEPARTMENT OF COMMERCE Economics and Statistics Administration U.S. Census Bureau

