

P. L. 94-171 COUNTY BLOCK MAP (CENSUS 2000)

38 035528N  
92 482023W

38 035528N  
92 377148W

GEOGRAPHIC AREAS LEGEND

SYMBOL	NAME STYLE
*****	INTERNATIONAL
//////	STATE
■■■■■	COUNTY
●●●●●	MINOR CIVIL DIV. <sup>1</sup>
	Incorporated Place <sup>2</sup>
	Census Designated Place <sup>2</sup>
.....	Corporate Offset Boundary
●●●●●	Voting District <sup>3</sup>
■■■■■	Census Tract
■■■■■	BLOCK <sup>3</sup>
	Military
	Inset
	Out Area

1 A "\*" following a place name indicates that the place is coterminous with a MCD. A "-" indicates that the place is also a false MCD. In both cases, the MCD name is shown only when it differs from the place name.  
 2 A "\*" following a VTD code indicates an actual voting district. Its absence indicates that the VTD is a pseudo voting district or no information is available as to its status.  
 3 A "\*" following a block number indicates that the block number is repeated elsewhere in the block.

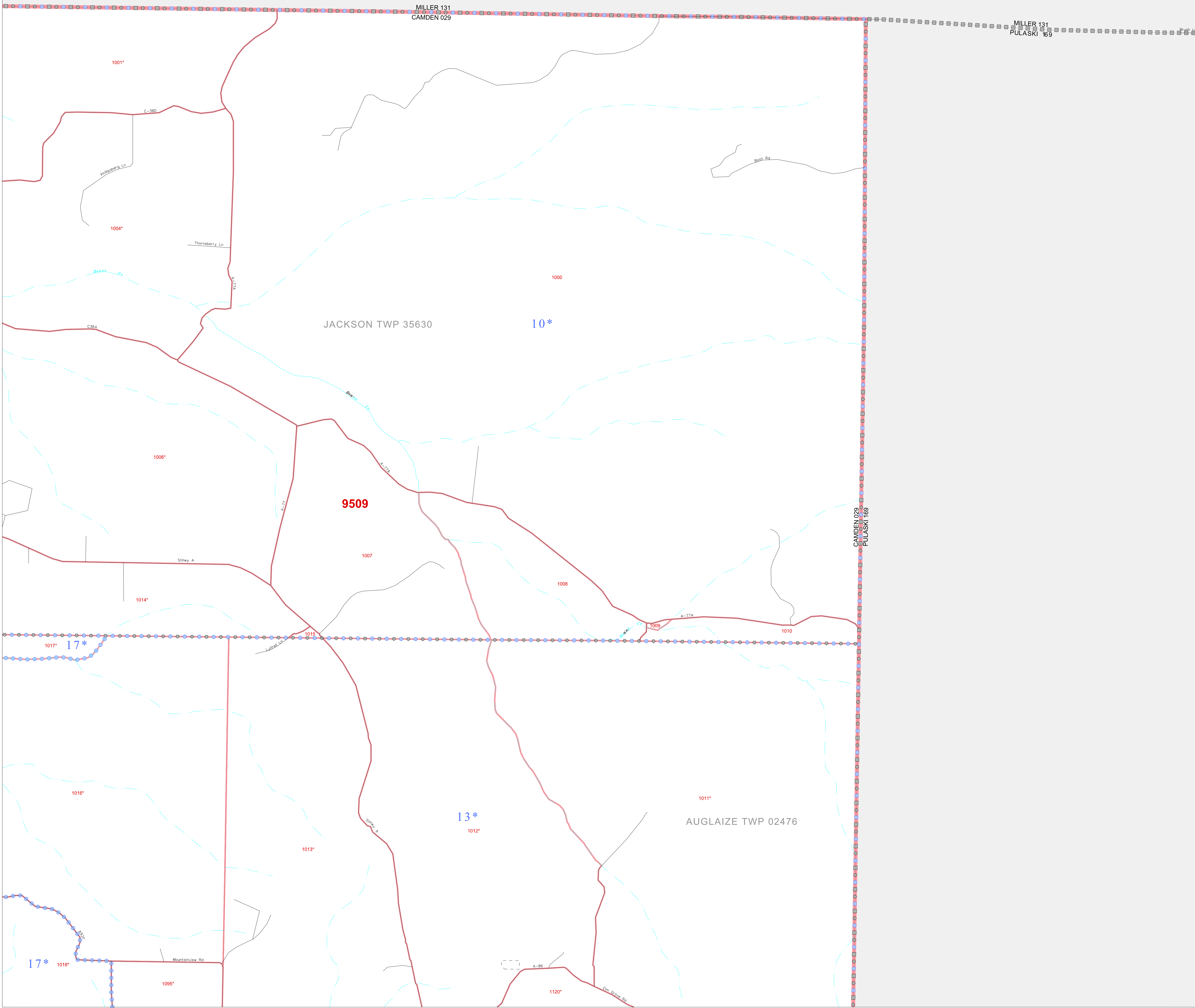

37 952573N  
92 482023W

37 952573N  
92 377148W

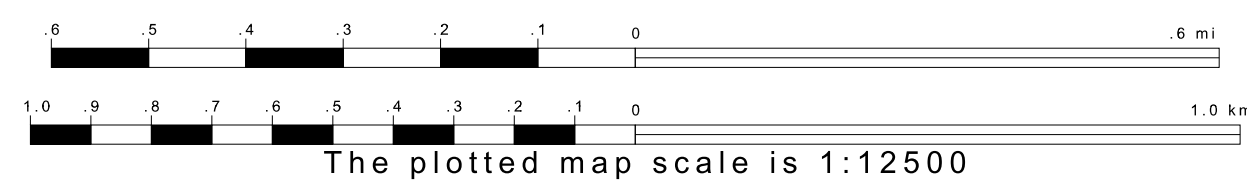
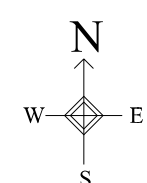

Sheet Location within County

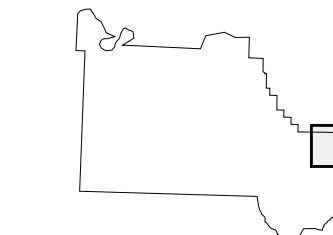

Key to Adjacent Sheets

15	22
21	28
28	29

ST: Missouri (29)  
 COU: Camden (029)  
 SHEET 22 OF 32 PARENT SHEETS

