

P.L. 94-171 VOTING DISTRICT/STATE LEGISLATIVE DISTRICT OUTLINE MAP (CENSUS 2000)

37 365384N  
93 933128W

37 365384N  
93 766878W

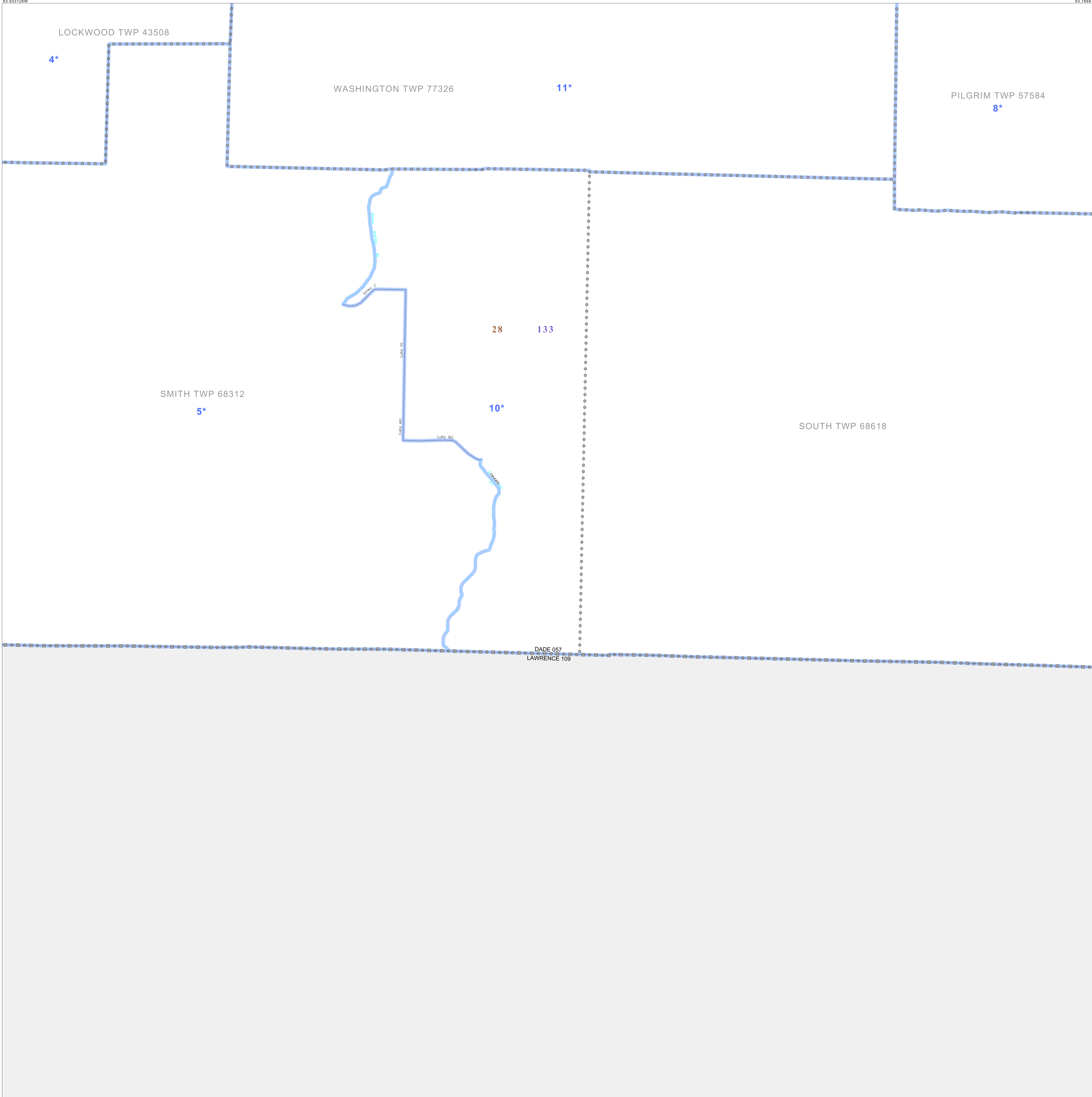

GEOGRAPHIC AREAS LEGEND

SYMBOL	NAME STYLE
*****	INTERNATIONAL
//////	STATE
□□□□	COUNTY
○○○○	MINOR CIVIL DIV <sup>1</sup>
■ ■ ■ ■	Incorporated Place <sup>1</sup>
■ ■ ■ ■	Census Designated Place <sup>2</sup>
—	Voting District
● ● ● ●	SLD-Senate
▲ ▲ ▲ ▲	SLD-House

Military  
 Inset  
 Out Area

Abbreviation Reference: AIR = American Indian Reservation; SDAISA = State Designated American Indian Statistical Area  
 1 A "\*" following a place name indicates that the place is coterminous with a MCD. A "-" indicates that the place is also a false MCD. In both cases, the MCD name is shown only when it differs from the place name.  
 2 A "\*" following a VTD code indicates an actual voting district. Its absence indicates that the VTD is a pseudo voting district or no information is available as to its status.

Voting Districts

Code	Name
4*	Eastlockwood Voting District
5*	Grant/Smith Voting District
8*	Pilgrim/Recreation Voting District
10*	South/Smith Voting District
11*	Washington Voting District

37 332644N  
93 933128W

37 332644N  
93 766878W

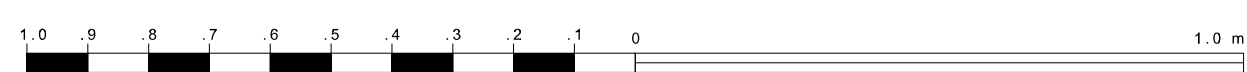
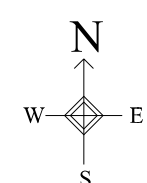

The plotted map scale is 1:20000

Sheet Location within County

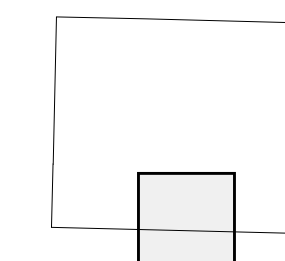

Key to Adjacent Sheets

4	5	6
7	8	9

ST: Missouri (29)  
 COU: Dade (057)  
 SHEET 8 OF 9 PARENT SHEETS