

P.L. 94-171 COUNTY BLOCK MAP (CENSUS 2000)

37 131460N
92.747076W

37 131460N
92.581722W

GEOGRAPHIC AREAS LEGEND

| SYMBOL | NAME STYLE |
|---------|--------------------------------------|
| ***** | INTERNATIONAL |
| /////// | STATE |
| ■■■■■ | COUNTY |
| □□□□□ | MINOR CIVIL DIV ¹ |
| ■■■■■ | Incorporated Place ² |
| ■■■■■ | Census Designated Place ² |
| | Corporate Offset Boundary |
| ●●●●● | Voting District ³ |
| ■■■■■ | Census Tract |
| ■■■■■ | BLOCK ³ |
| ■ | Military |
| ■ | Inset |
| ■ | Out Area |

1 A "*" following a place name indicates that the place is coterminous with a MCD. A "-" indicates that the place is also a false MCD. In both cases, the MCD name is shown only when it differs from the place name.
 2 A "*" following a VTD code indicates an actual voting district. Its absence indicates that the VTD is a pseudo voting district or no information is available as to its status.
 3 A "*" following a block number indicates that the block number is repeated elsewhere in the block.

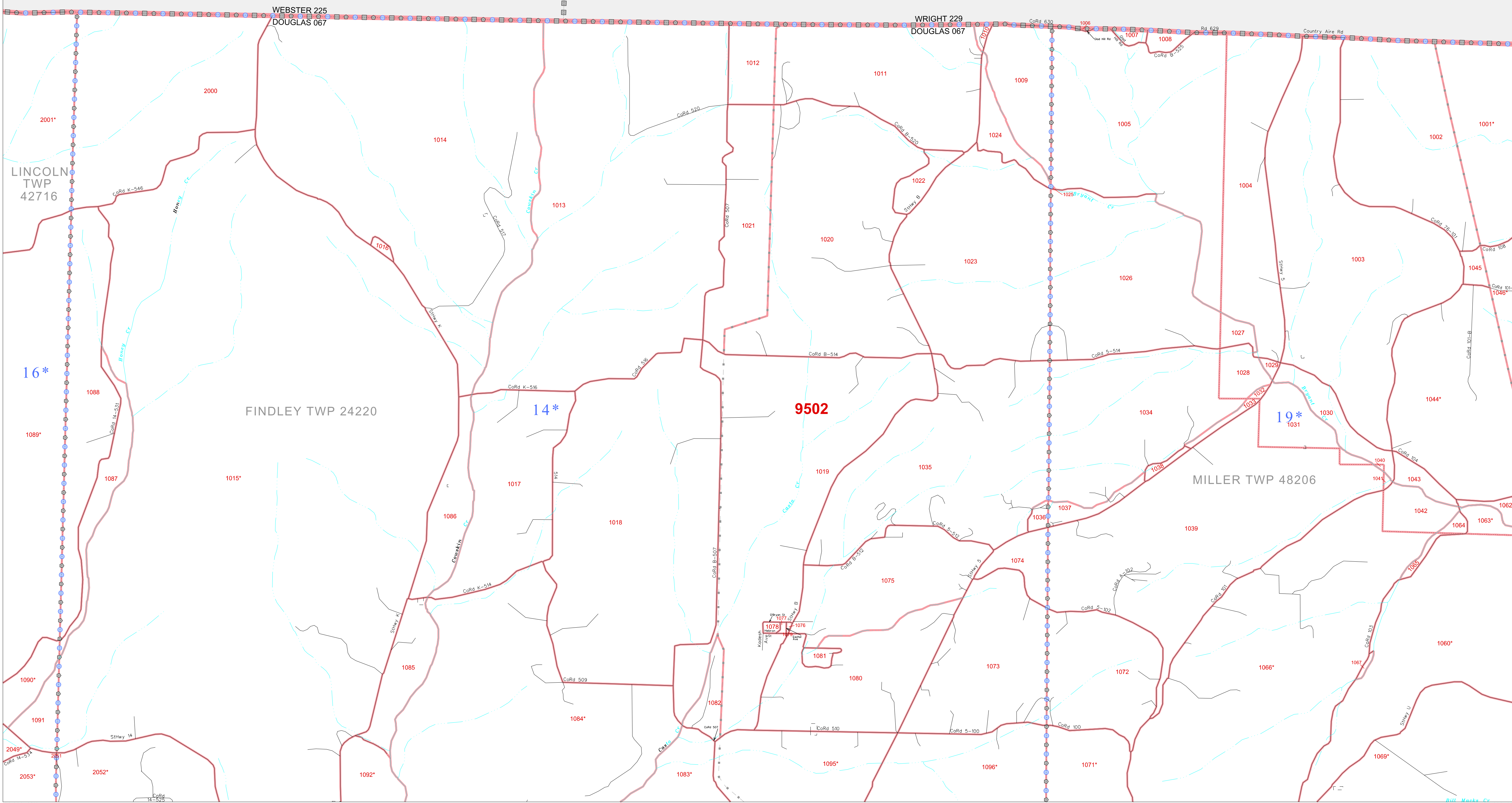

38 938728N
92.747076W

38 938728N
92.581722W



The plotted map scale is 1:20000

Sheet Location within County

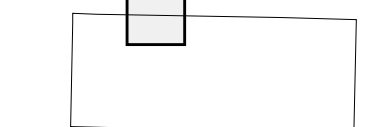

Key to Adjacent Sheets

| | | |
|---|---|---|
| 1 | 2 | 3 |
| 6 | 7 | 8 |

ST: Missouri (29)
 COU: Douglas (067)
 SHEET 2 OF 15 PARENT SHEETS

