

P.L. 94-171 VOTING DISTRICT/STATE LEGISLATIVE DISTRICT OUTLINE MAP (CENSUS 2000)

38 490961N  
91 652827W

38 490961N  
91 652827W



**GEOGRAPHIC AREAS LEGEND**

| SYMBOL  | NAME STYLE                           |
|---------|--------------------------------------|
| *****   | INTERNATIONAL                        |
| //////  | STATE                                |
| □□□□    | COUNTY                               |
| ○ ○ ○ ○ | MINOR CIVIL DIV <sup>1</sup>         |
| ■ ■ ■ ■ | Incorporated Place <sup>1</sup>      |
| ■ ■ ■ ■ | Census Designated Place <sup>1</sup> |
| — — — — | Voting District <sup>2</sup>         |
| ● ● ● ● | SLD—Senate                           |
| ▲ ▲ ▲ ▲ | SLD—House                            |
| □ □ □ □ | Minority                             |
| □ □ □ □ | Inset                                |
| □ □ □ □ | Out Area                             |

Abbreviation Reference: AIR = American Indian Reservation; SDAISA = State Designated American Indian Statistical Area

<sup>1</sup> A "\*" following a place name indicates that the place is coterminous with a MCD. A "-" indicates that the place is also a MCD. In both cases, the MCD name is shown only when it differs from the place name.

<sup>2</sup> A "\*" following a VTD code indicates an actual voting district. Its absence indicates that the VTD is a pseudo voting district or no information is available as to its status.

**Voting Districts**

| Code | Name                          |
|------|-------------------------------|
| 2*   | Bay Voting District           |
| 10*  | Wt. Sterling Voting District  |
| 11*  | Gasconade TWP Voting District |
| 22*  | ThirdCreek Voting District    |

38 374833N  
91 652827W

38 374833N  
91 652827W

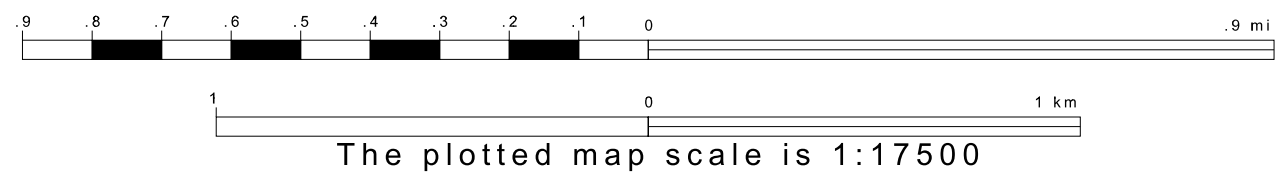

Sheet Location within County

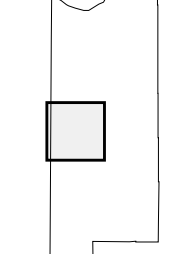

Key to Adjacent Sheets

|   |   |
|---|---|
| 3 | 4 |
| 5 | 6 |
| 7 | 8 |

ST: Missouri (29)  
COU: Gasconade (073)  
SHEET 5 OF 10 PARENT SHEETS

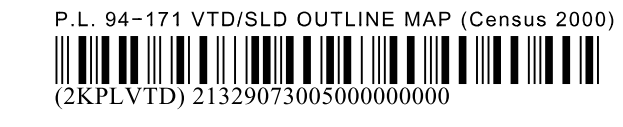

All legal boundaries and names are as of January 1, 2000. The boundaries shown on this map are for Census Bureau statistical data collection and tabulation purposes only; their depiction and designation for statistical purposes does not constitute a determination of jurisdictional authority or rights of ownership or entitlement. U.S. DEPARTMENT OF COMMERCE Economics and Statistics Administration U.S. Census Bureau