

37 457188N  
93 509736W

37 457188N  
93 343673W

**GEOGRAPHIC AREAS LEGEND**

SYMBOL	NAME STYLE
*****	INTERNATIONAL
//////	STATE
□□□□□□	COUNTY
○ ○ ○ ○ ○	MINOR CIVIL DIV. <sup>1</sup>
■ ■ ■ ■ ■	Incorporated Place <sup>1</sup>
■ ■ ■ ■ ■	Census Designated Place <sup>2</sup>
▬▬▬▬▬	Voting District
● ● ● ● ●	SLD-Senate
▲ ▲ ▲ ▲ ▲	SLD-House
⋮	Minority
⊞	Inset
⊞	Out Area

Abbreviation Reference: AIR - American Indian Reservation; SDAISA - State Designated American Indian Statistical Area

<sup>1</sup> A "\*" following a place name indicates that the place is coterminous with a MCD. A "-" indicates that the place is also a false MCD. In both cases, the MCD name is shown only when it differs from the place name.

<sup>2</sup> A "\*" following a VTD code indicates an actual voting district. Its absence indicates that the VTD is a pseudo voting district or no information is available as to its status.

**Voting Districts**

Code	Name
2*	Boone1 Voting District
14*	Cass-McSchool Voting District
28*	MurrayMcSchool Voting District
31*	Robberson1A Voting District
32*	Robberson1B Voting District
33*	Robberson2 Voting District
109*	WaltonGreen Voting District

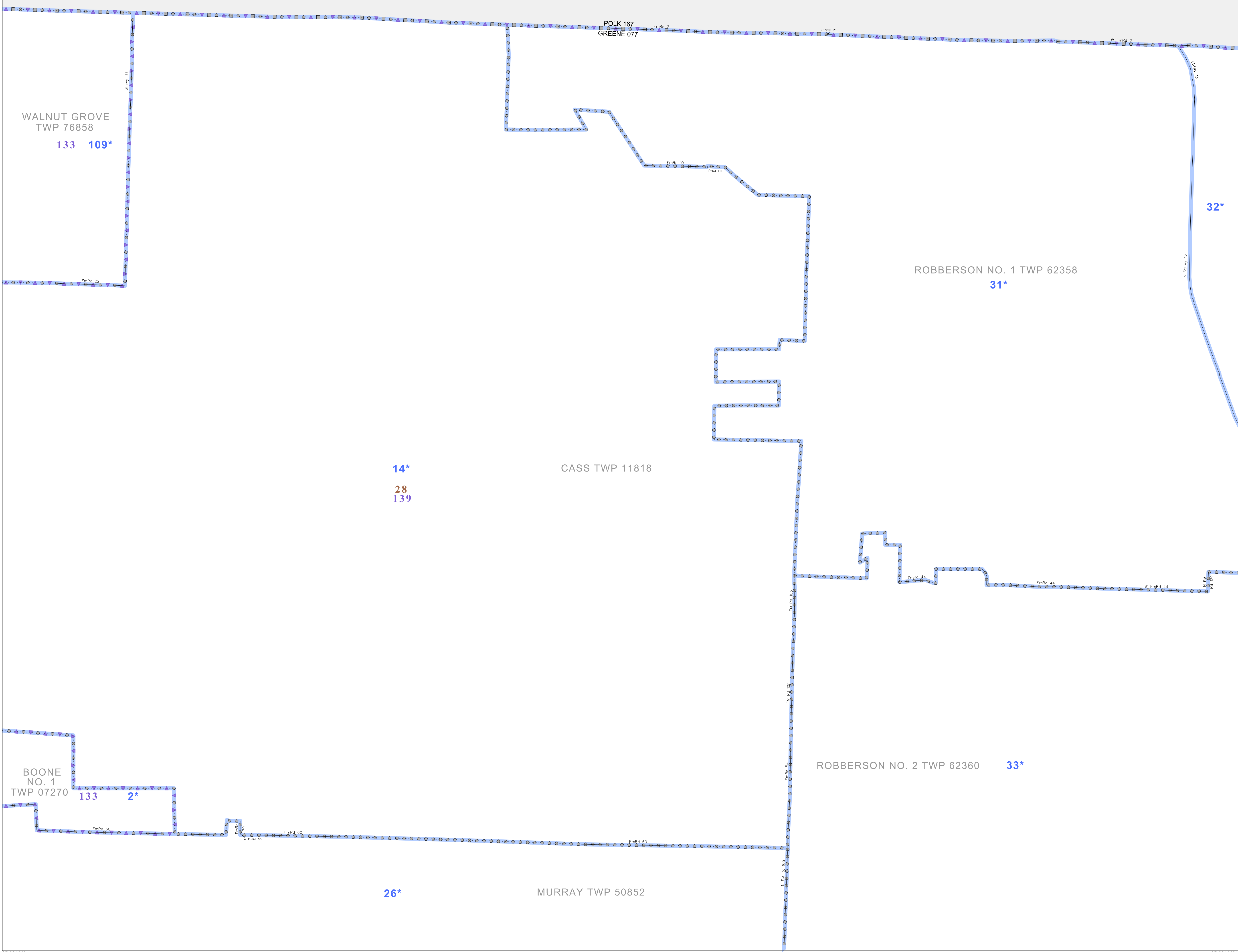

37 324443N  
93 509736W

37 324443N  
93 343673W

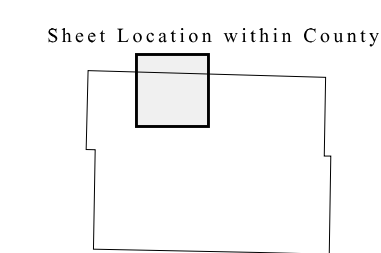
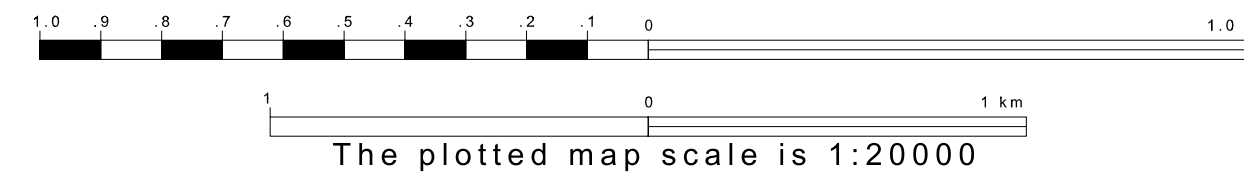

Key to Adjacent Sheets

1	2	3
5	6	7

ST: Missouri (29)  
COU: Greene (077)  
SHEET 2 OF 12 PARENT SHEETS

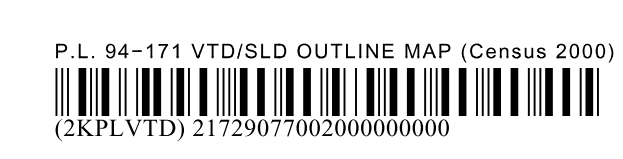

All legal boundaries and names are as of January 1, 2000. The boundaries shown on this map are for Census Bureau statistical data collection and tabulation purposes only; their depiction and designation for statistical purposes does not constitute a determination of jurisdictional authority or rights of ownership or entitlement. U.S. DEPARTMENT OF COMMERCE Economics and Statistics Administration U.S. Census Bureau