

P.L. 94-171 VOTING DISTRICT/STATE LEGISLATIVE DISTRICT OUTLINE MAP (CENSUS 2000)

38 846100N  
94 150157W

38 846100N  
93 980999W

**GEOGRAPHIC AREAS LEGEND**

SYMBOL	NAME STYLE
*****	INTERNATIONAL
//////	STATE
□□□□	COUNTY
○	MINOR CIVIL DIV <sup>1</sup>
■	Incorporated Place <sup>1</sup>
■	Census Designated Place <sup>2</sup>
■	Voting District
●	SLD-Senate
▲	SLD-House

Military  
 Inset  
 Out Area

Abbreviation Reference: AIR - American Indian Reservation; SDAISA - State Designated American Indian Statistical Area

<sup>1</sup> A "\*" following a place name indicates that the place is coterminous with a MCD. A "-" indicates that the place is also a MCD. In both cases, the MCD name is shown only when it differs from the place name.  
<sup>2</sup> A "\*" following a VTD code indicates an actual voting district. Its absence indicates that the VTD is a pseudo voting district or no information is available as to its status.

**Voting Districts**

Code	Name
13*	Pittsville Voting District

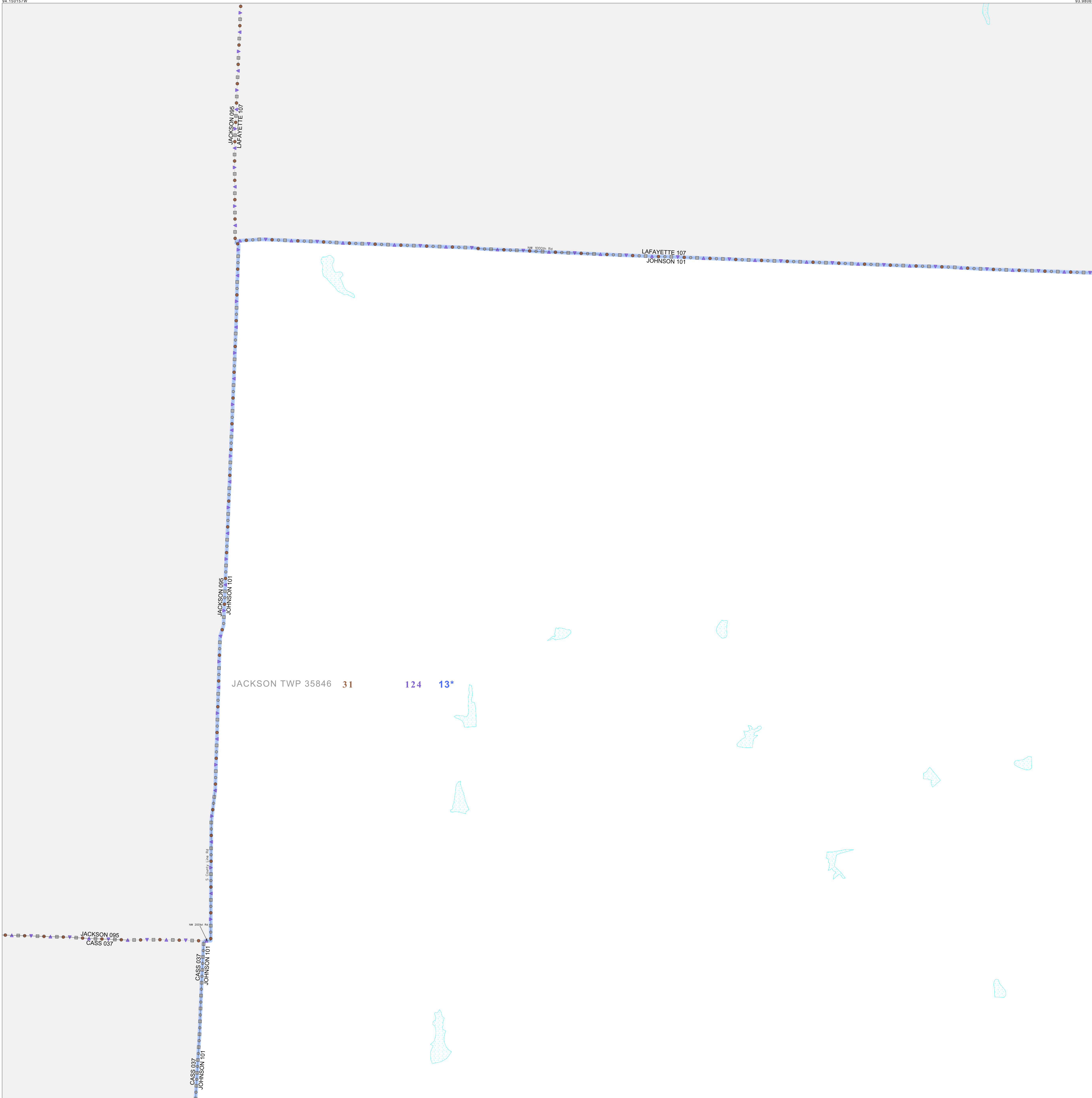

JACKSON TWP 35846 31 124 13\*

LAFAYETTE 107  
JOHNSON 101

JACKSON 095  
CASS 037

CASS 037  
JOHNSON 101

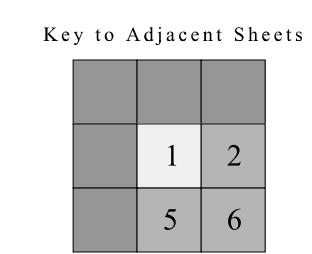
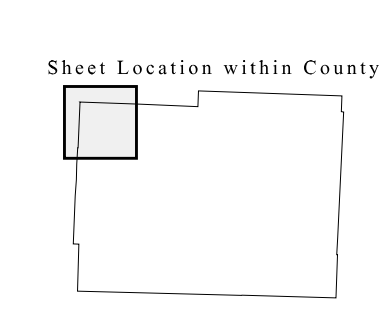
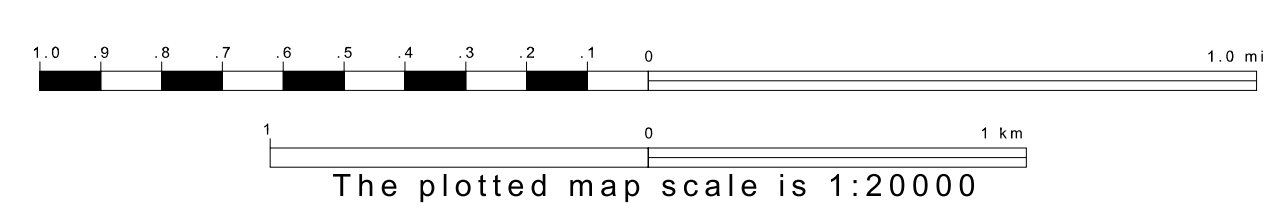
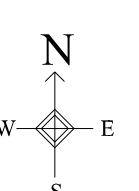

ST: Missouri (29)  
COU: Johnson (101)  
SHEET 1 OF 12 PARENT SHEETS

