

P.L. 94-171 VOTING DISTRICT/STATE LEGISLATIVE DISTRICT OUTLINE MAP (CENSUS 2000)

40 107483N  
93 416074W

40 107483N  
93 209452W

**GEOGRAPHIC AREAS LEGEND**

| SYMBOL      | NAME STYLE                           |
|-------------|--------------------------------------|
| *****       | INTERNATIONAL                        |
| //////      | STATE                                |
| □□□□□□      | COUNTY                               |
| ○ ○ ○ ○ ○ ○ | MINOR CIVIL DIV <sup>1</sup>         |
| ■ ■ ■ ■ ■ ■ | Incorporated Place <sup>1</sup>      |
| ■ ■ ■ ■ ■ ■ | Census Designated Place <sup>2</sup> |
| ▬▬▬▬▬▬      | Voting District                      |
| ● ● ● ● ● ● | SLD-Senate                           |
| ▲ ▲ ▲ ▲ ▲ ▲ | SLD-House                            |
| □ □ □ □ □ □ | Minority                             |
| □ □ □ □ □ □ | Inset                                |
| □ □ □ □ □ □ | Out Area                             |

Abbreviation Reference: AIR - American Indian Reservation; SDAISA - State Designated American Indian Statistical Area

<sup>1</sup> A "\*" following a place name indicates that the place is coterminous with a MCD. A "-" indicates that the place is also a MCD. In both cases, the MCD name is shown only when it differs from the place name.

<sup>2</sup> A "\*" following a VTD code indicates an actual voting district. Its absence indicates that the VTD is a pseudo voting district or no information is available as to its status.

**Voting Districts**

| Code | Name                        |
|------|-----------------------------|
| 3*   | BentonNorth Voting District |
| 4*   | BentonSouth Voting District |
| 13*  | Jackson Voting District     |

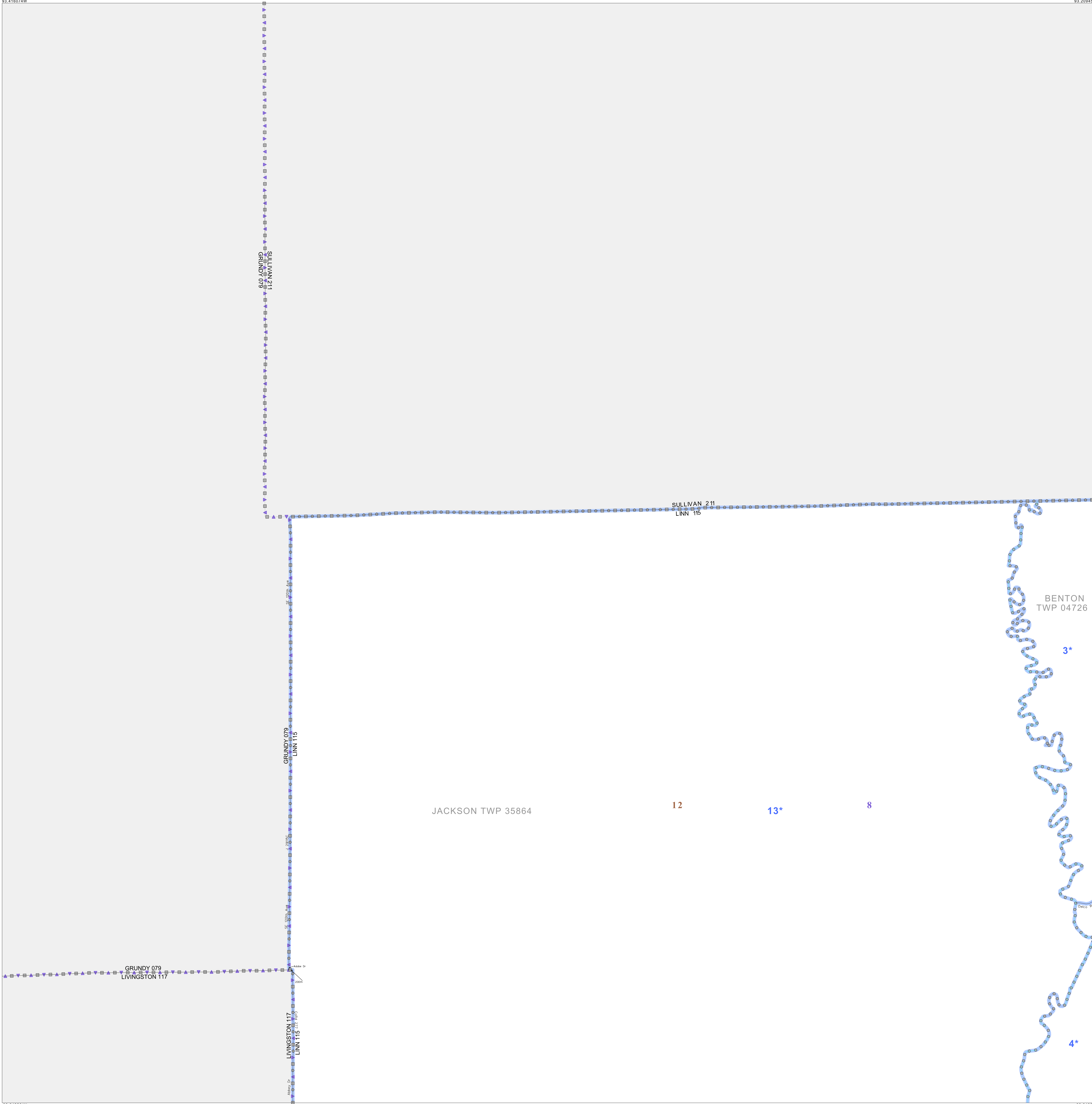

39 048251N  
93 416074W

39 048251N  
93 209452W

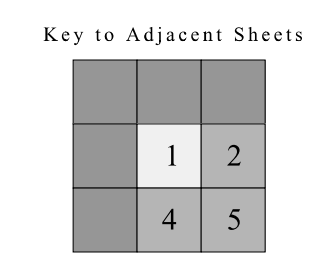
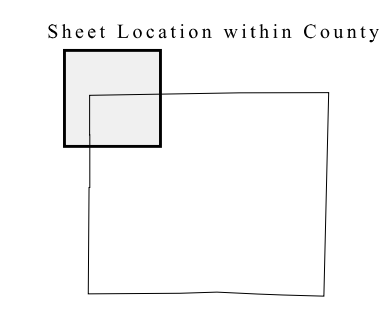

ST: Missouri (29)  
COU: Linn (115)  
SHEET 1 OF 9 PARENT SHEETS

