

P. L. 94-171 COUNTY BLOCK MAP (CENSUS 2000)

37 590170N  
93 319375W

37 590170N  
93 319375W

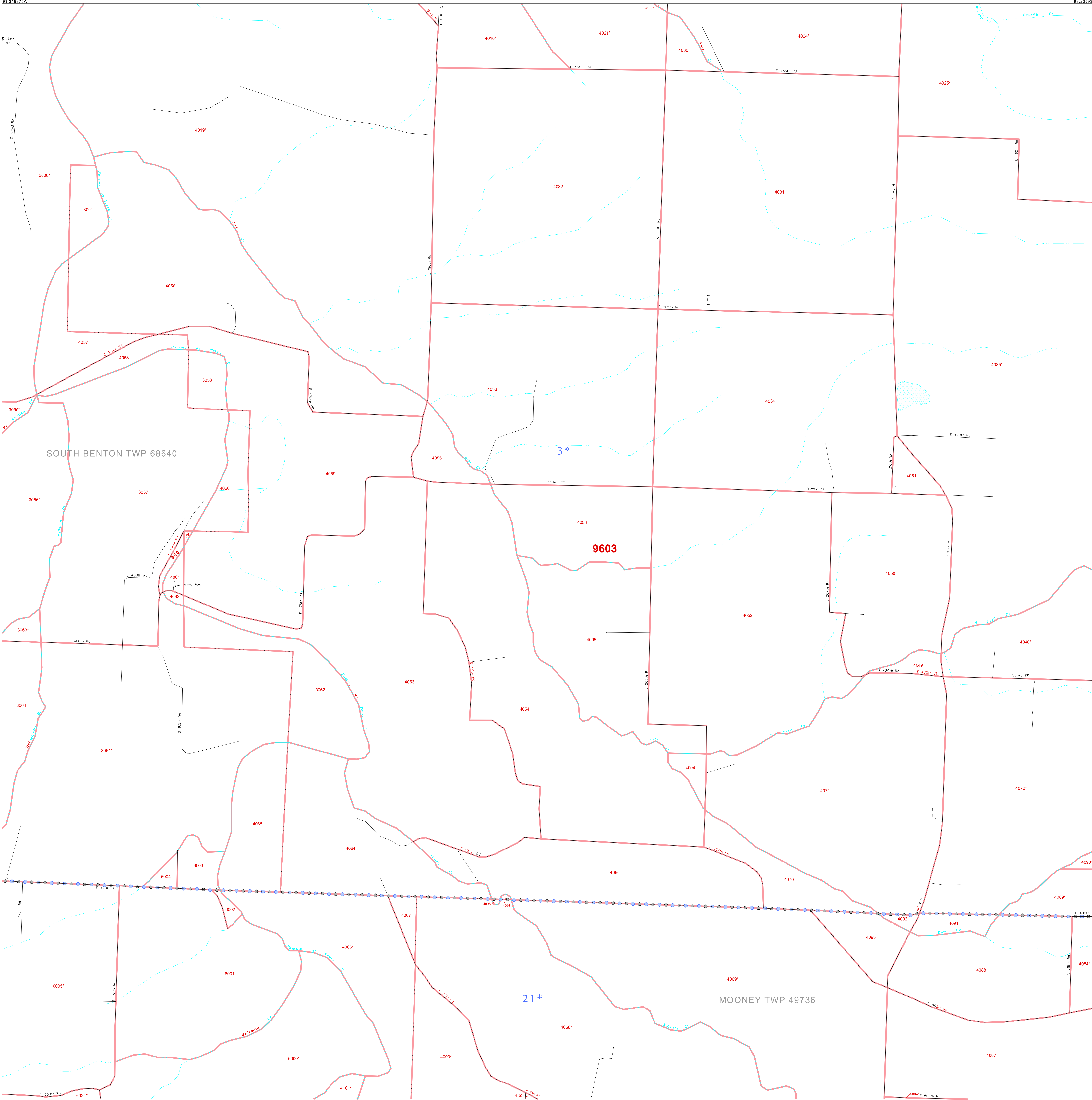

GEOGRAPHIC AREAS LEGEND

SYMBOL	NAME STYLE
☆☆☆☆	INTERNATIONAL
//////	STATE
□□□□	COUNTY
○●○●	MINOR CIVIL DIV. <sup>1</sup>
Yellow box	Incorporated Place <sup>1</sup>
Light blue box	Census Designated Place <sup>1</sup>
Red dashed line	Corporate Offset Boundary
Blue dashed line	Voting District <sup>2</sup>
Red solid line	Census Tract
Red dashed line	BLOCK <sup>3</sup>

1 A "\*" following a place name indicates that the place is coterminous with a MCD. A "-" indicates that the place is also a false MCD. In both cases, the MCD name is shown only when it differs from the place name.

2 A "\*" following a VTD code indicates an actual voting district. Its absence indicates that the VTD is a pseudo voting district or no information is available as to its status.

3 A "\*" following a block number indicates that the block number is repeated elsewhere in the block.

Military Inset Out Area

37 523862N  
93 319375W

37 523862N  
93 319375W

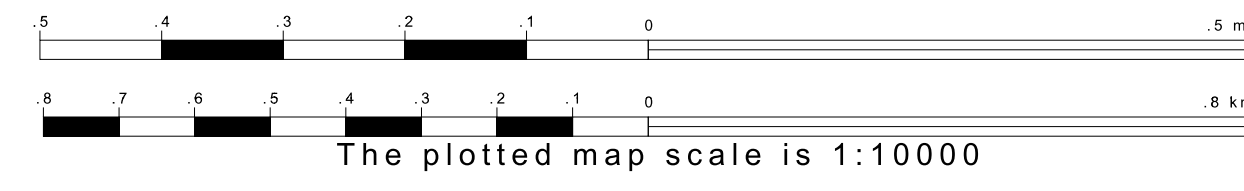
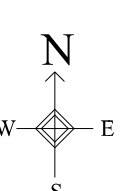

Sheet Location within County

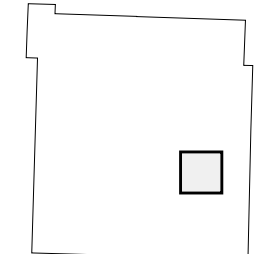

Key to Adjacent Sheets

22	23	24
28	29	30
34	35	36

ST: Missouri (29)  
COU: Polk (167)  
SHEET 29 OF 42 PARENT SHEETS

