

P. L. 94-171 COUNTY BLOCK MAP (CENSUS 2000)

37 457434N  
93 152500W

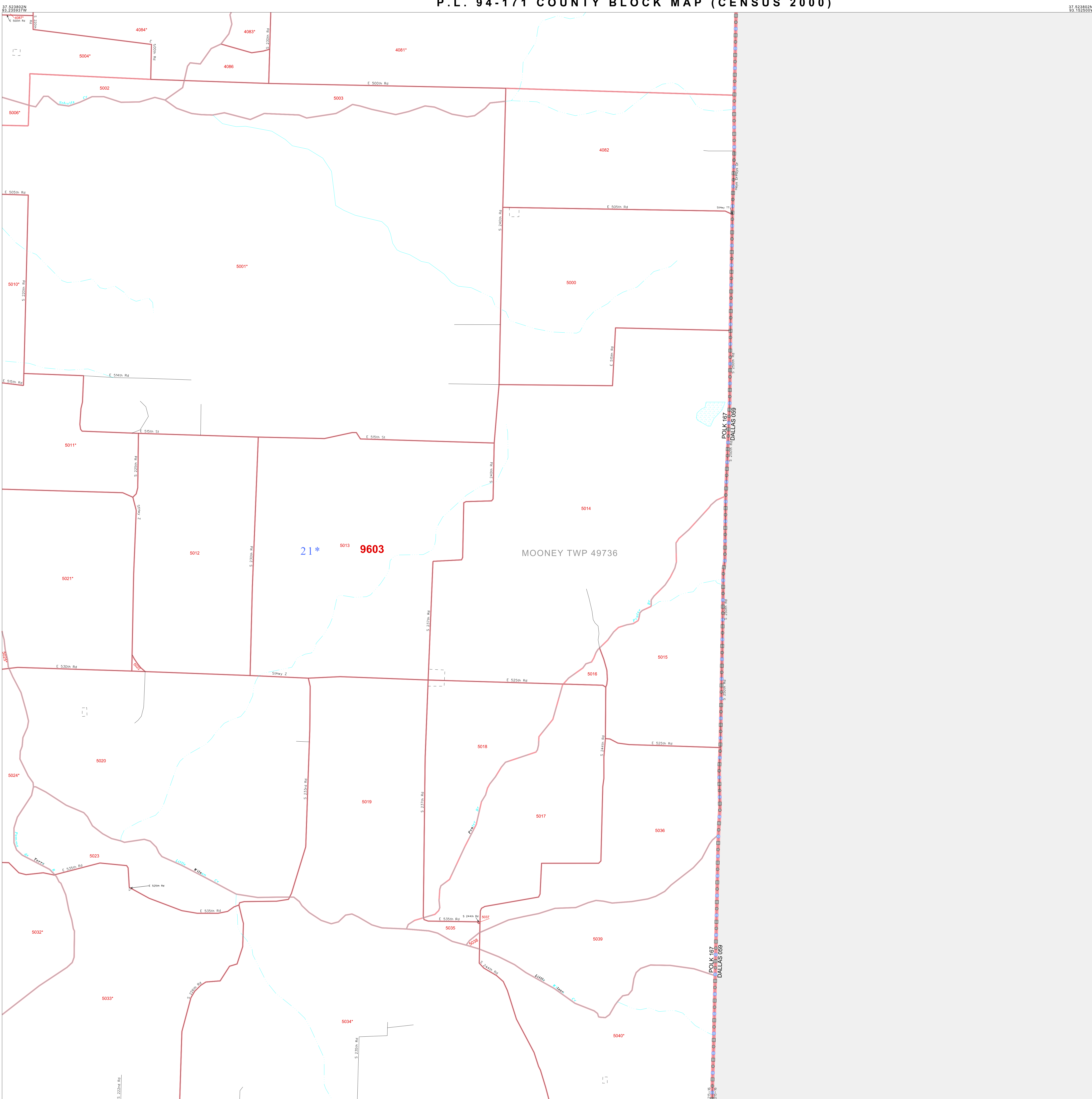

**GEOGRAPHIC AREAS LEGEND**

SYMBOL	NAME STYLE
*****	INTERNATIONAL
///////	STATE
□□□□□	COUNTY
○ ○ ○ ○ ○	MINOR CIVIL DIV <sup>1</sup>
Yellow box	Incorporated Place <sup>1</sup>
Light yellow box	Census Designated Place <sup>1</sup>
.....	Corporate Offset Boundary
●●●●●	Voting District <sup>2</sup>
Red line	Census Tract
Red line	BLOCK <sup>3</sup>
Blue dashed box	Military
Inset box	Inset
Out Area box	Out Area

1 A "\*" following a place name indicates that the place is coterminous with a MCD. A "-" indicates that the place is also a false MCD. In both cases, the MCD name is shown only when it differs from the place name.

2 A "\*" following a VTD code indicates an actual voting district. Its absence indicates that the VTD is a pseudo voting district or no information is available as to its status.

3 A "\*" following a block number indicates that the block number is repeated elsewhere in the block.

37 457434N  
93 152500W

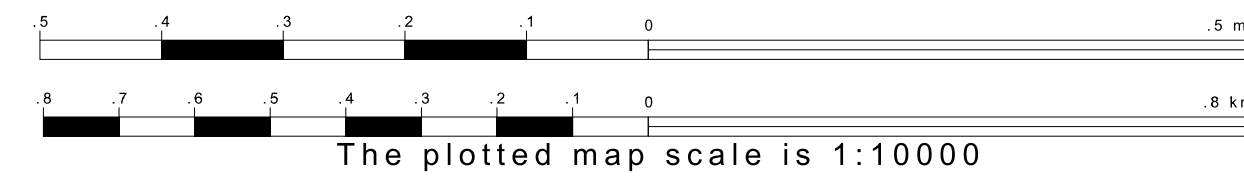
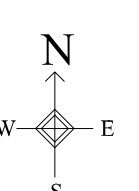

Sheet Location within County

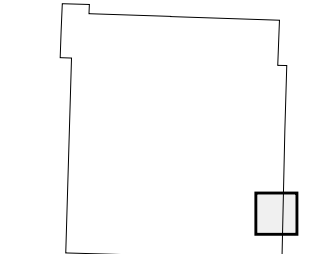

Key to Adjacent Sheets

29	30
35	36
41	42

ST: Missouri (29)  
COU: Polk (167)  
SHEET 36 OF 42 PARENT SHEETS

