

P. L. 94-171 COUNTY BLOCK MAP (CENSUS 2000)

37 495162N  
91.503342W

37 495162N  
91.337666W

GEOGRAPHIC AREAS LEGEND

SYMBOL	NAME STYLE
*****	INTERNATIONAL
//////	STATE
□□□□	COUNTY
○●○●○●	MINOR CIVIL DIV. <sup>1</sup>
■	Incorporated Place <sup>2</sup>
■	Census Designated Place <sup>2</sup>
-----	Corporate Offset Boundary
●●●●●	Voting District <sup>3</sup>
—	Census Tract
—	BLOCK <sup>3</sup>
■	Military
Inset	Inset
Out Area	Out Area

1 A "" following a place name indicates that the place is coterminous with a MCD. A "" indicates that the place is also a false MCD. In both cases, the MCD name is shown only when it differs from the place name.  
 2 A "" following a VTD code indicates an actual voting district. Its absence indicates that the VTD is a pseudo voting district or no information is available as to its status.  
 3 A "" following a block number indicates that the block number is repeated elsewhere in the block.

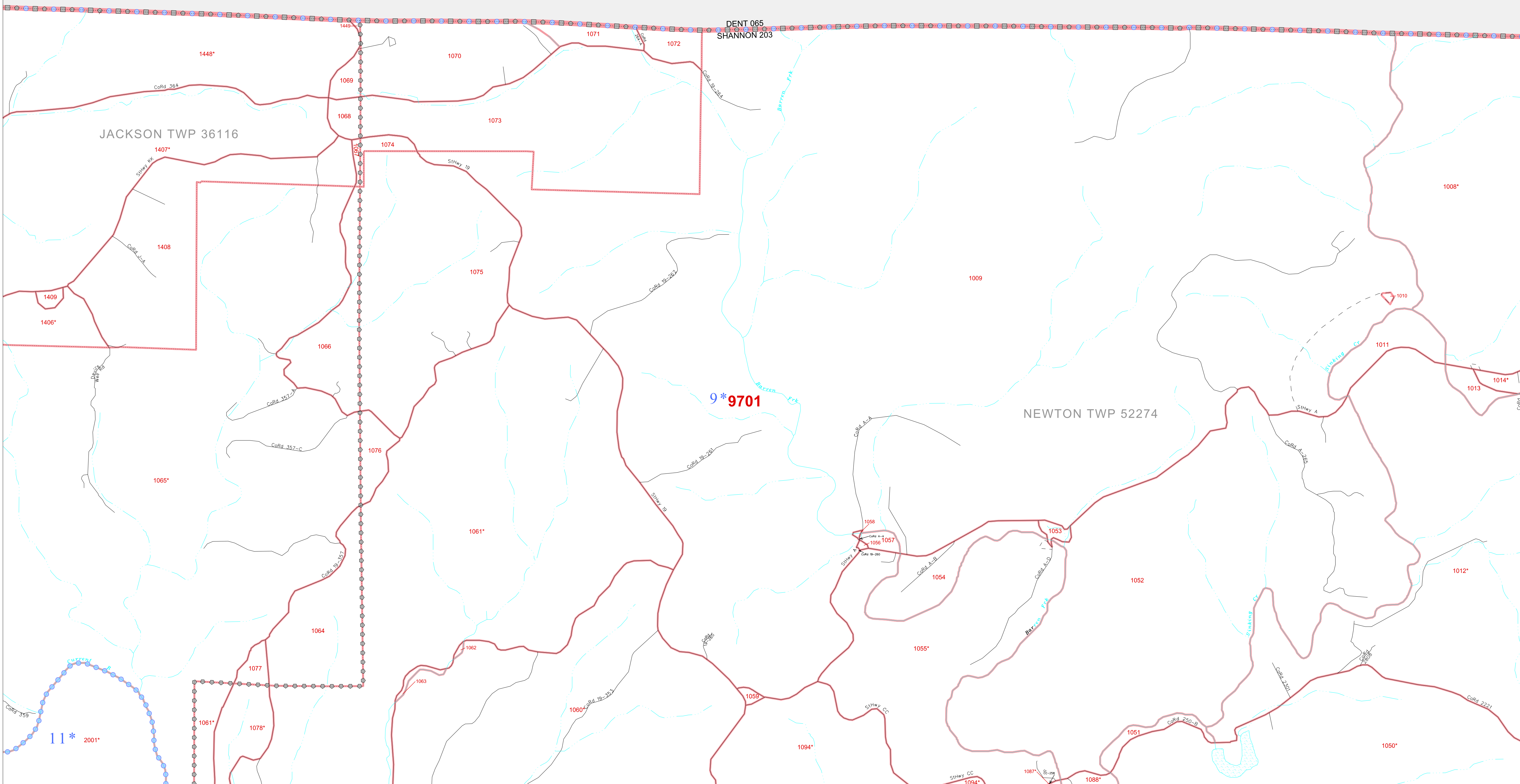

37 352415N  
91.503342W

37 352415N  
91.337666W

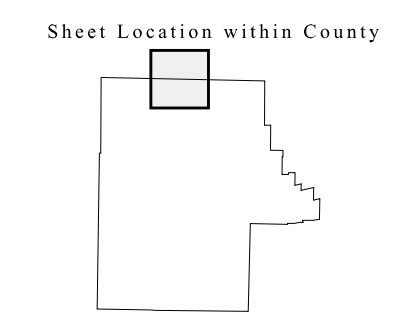

Key to Adjacent Sheets

1	2	3
4	5	6

ST: Missouri (29)  
 COU: Shannon (203)  
 SHEET 2 OF 18 PARENT SHEETS

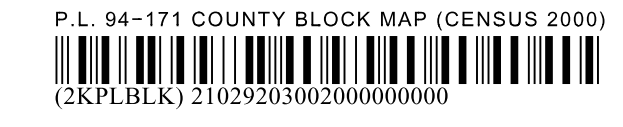

All legal boundaries and names are as of January 1, 2000. The boundaries shown on this map are for Census Bureau statistical data collection and tabulation purposes only; their depiction and designation for statistical purposes does not constitute a determination of jurisdictional authority or rights of ownership or entitlement. U.S. DEPARTMENT OF COMMERCE Economics and Statistics Administration U.S. Census Bureau