

P. L. 94-171 COUNTY BLOCK MAP (CENSUS 2000)

37 664057N
94 170859W

37 664057N
94 172347W

GEOGRAPHIC AREAS LEGEND

SYMBOL	NAME STYLE
*****	INTERNATIONAL
///////	STATE
□□□□□	COUNTY
○●○●○●	MINOR CIVIL DIV ¹
Yellow shaded area	Incorporated Place ¹
Light blue shaded area	Census Designated Place ¹
.....	Corporate Offset Boundary
●●●●●	Voting District ²
Red line	Census Tract
Red line	BLOCK ³
Military symbol	Military
Inset box	Inset
Out Area box	Out Area

1 A "*" following a place name indicates that the place is coterminous with a MCD. A "-" indicates that the place is also a false MCD. In both cases, the MCD name is shown only when it differs from the place name.

2 A "*" following a VTD code indicates an actual voting district. Its absence indicates that the VTD is a pseudo voting district or no information is available as to its status.

3 A "*" following a block number indicates that the block number is repeated elsewhere in the block.

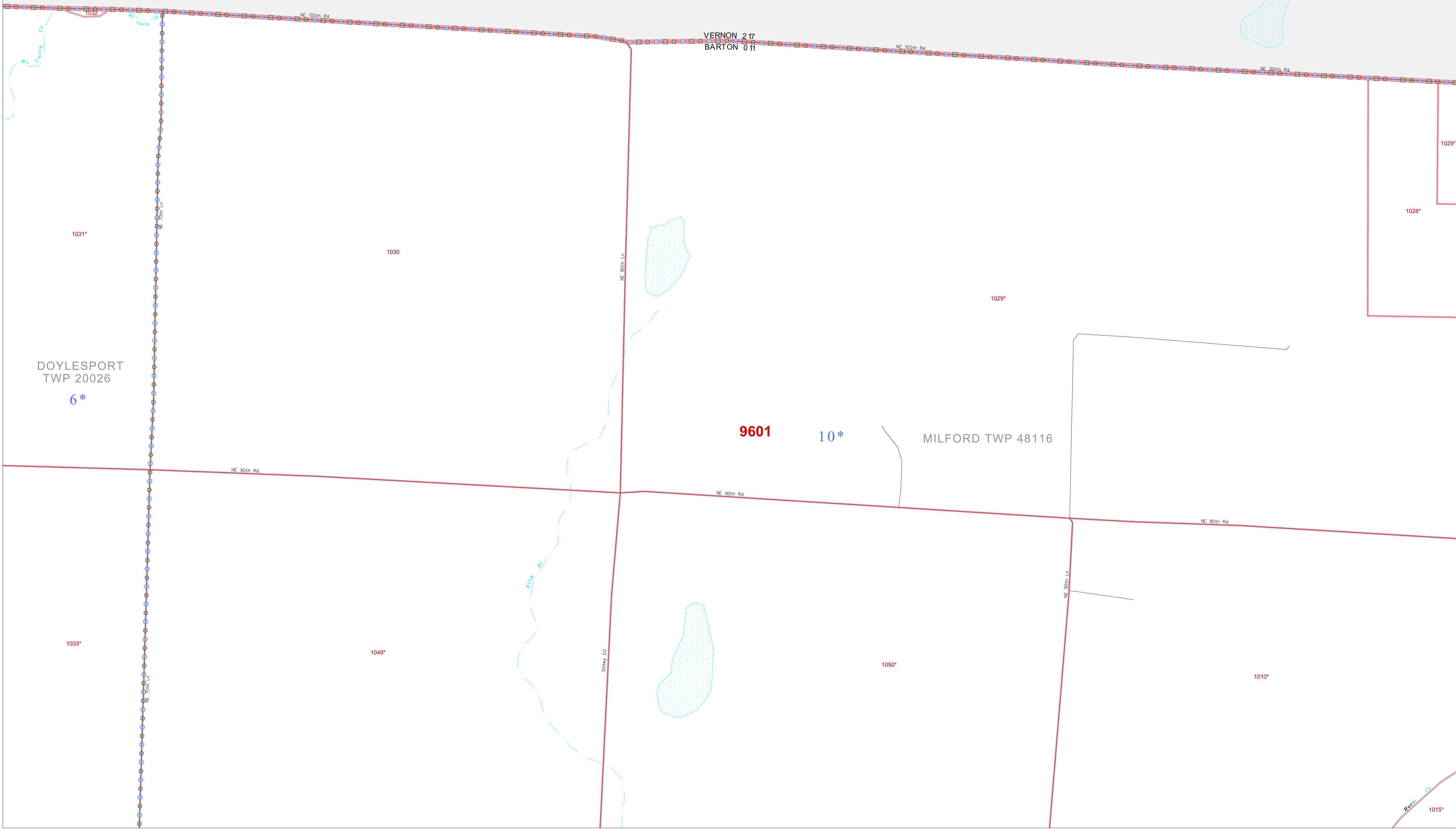

37 617599N
94 170859W

37 617599N
94 172347W

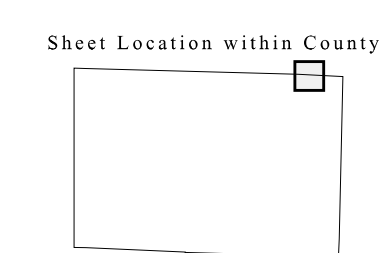
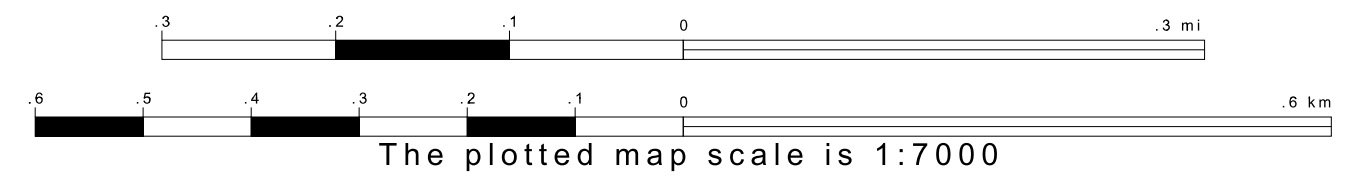
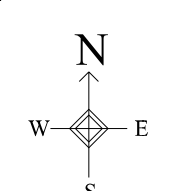

Key to Adjacent Sheets

8	9	10
18	19	20

ST: Missouri (29)
COU: Barton (011)
SHEET 9 OF 70 PARENT SHEETS

