

P. L. 94-171 COUNTY BLOCK MAP (CENSUS 2000)

37 524681N  
94.578835W

37 524681N  
94.520524W

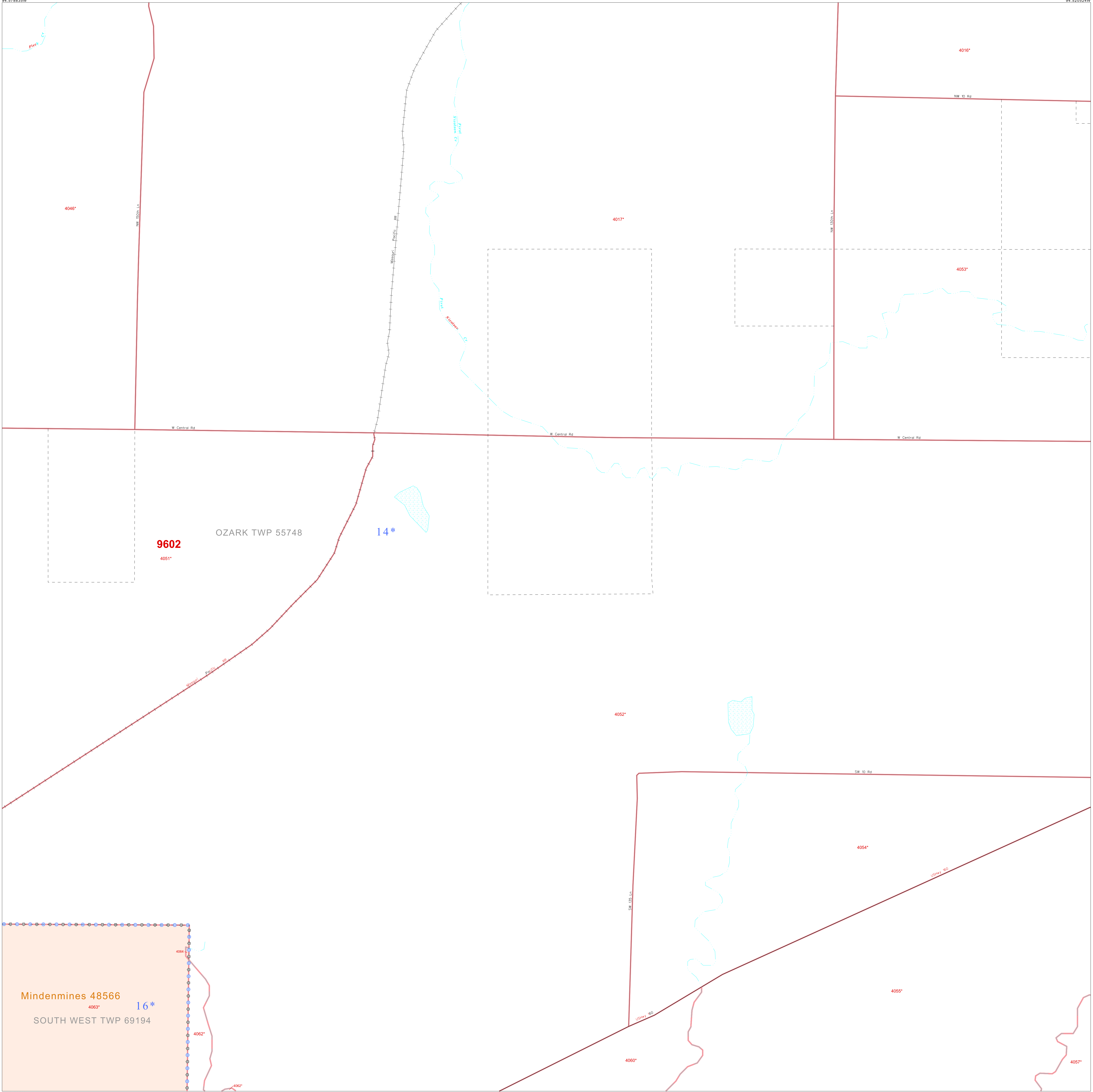

**GEOGRAPHIC AREAS LEGEND**

SYMBOL	NAME STYLE
*****	INTERNATIONAL
///////	STATE
#####	COUNTY
-----	MINOR CIVIL DIV <sup>1</sup>
Yellow/Pink	Incorporated Place <sup>1</sup>
Yellow/Pink	Census Designated Place <sup>1</sup>
.....	Corporate Offset Boundary
.....	Voting District <sup>2</sup>
Red Line	Census Tract
Red Line	BLOCK <sup>3</sup>
Blue Dashed Box	Military
Grey Box	Inset
White Box	Out Area

<sup>1</sup> A "\*" following a place name indicates that the place is coterminous with a MCD. A "-" indicates that the place is also a false MCD. In both cases, the MCD name is shown only when it differs from the place name.

<sup>2</sup> A "\*" following a VTD code indicates an actual voting district. Its absence indicates that the VTD is a pseudo voting district or no information is available as to its status.

<sup>3</sup> A "-" following a block number indicates that the block number is separated elsewhere in the block.

37 478223N  
94.578835W

37 478223N  
94.520524W

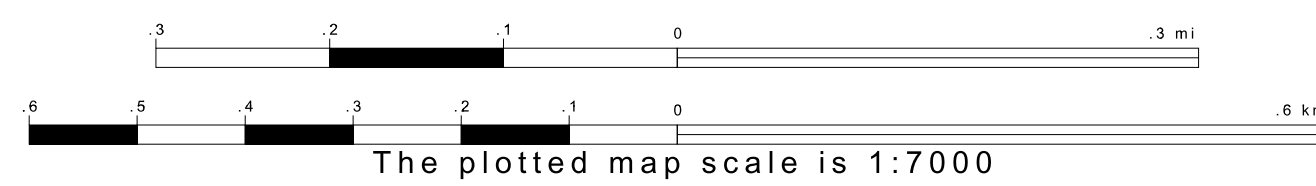
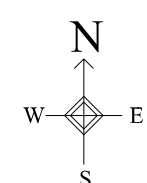

Sheet Location within County

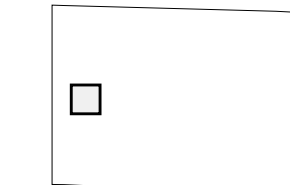

Key to Adjacent Sheets

21	22	23
31	32	33
41	42	43

ST: Missouri (29)  
COU: Barton (011)  
SHEET 32 OF 70 PARENT SHEETS

