

P.L. 94-171 VOTING DISTRICT/STATE LEGISLATIVE DISTRICT OUTLINE MAP (CENSUS 2000)

38 463845N
94 096718W

38 463845N
94 096718W

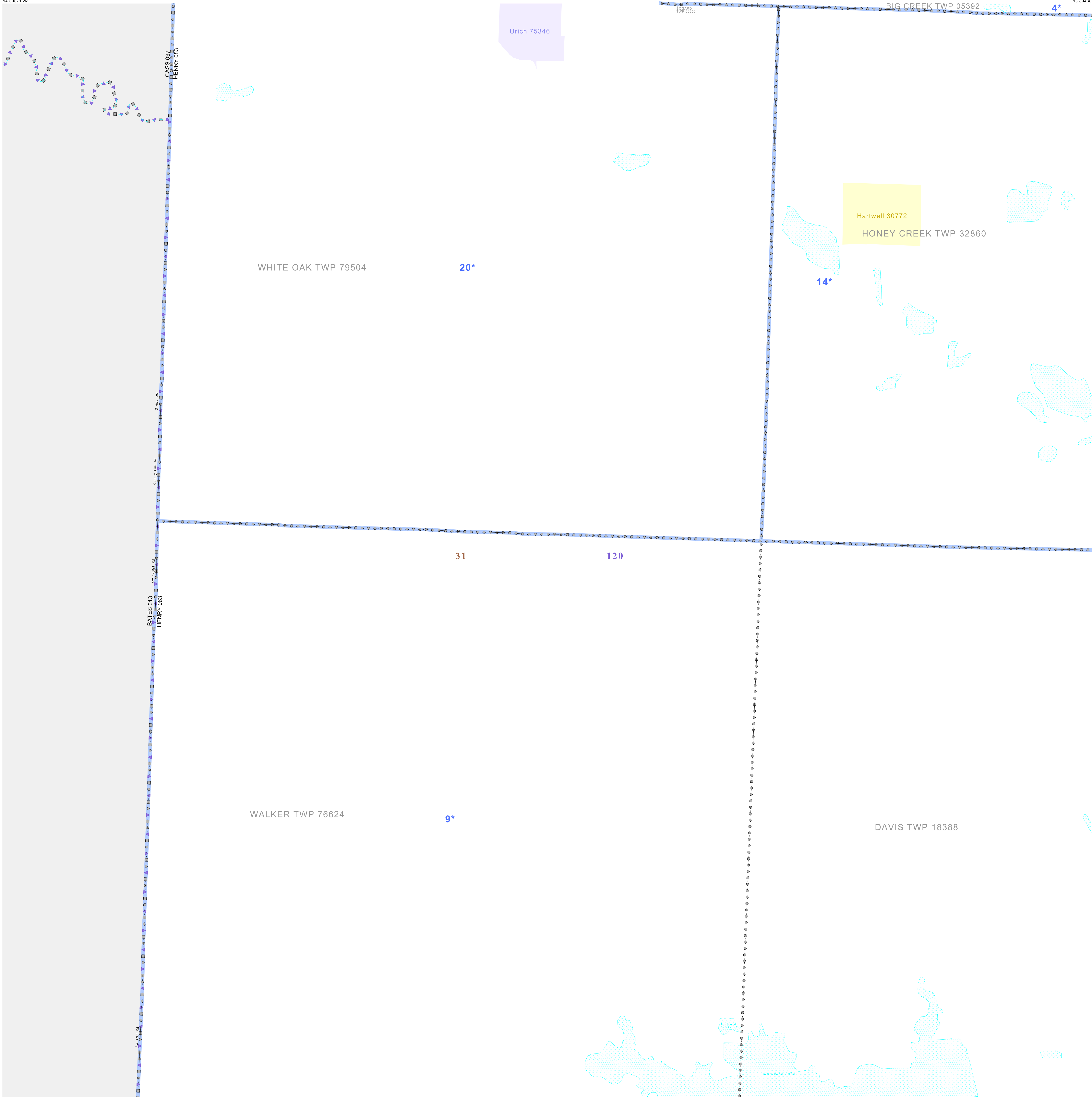

GEOGRAPHIC AREAS LEGEND

SYMBOL	NAME STYLE
*****	INTERNATIONAL
//////	STATE
□□□□	COUNTY
○	MINOR CIVIL DIV. ¹
■	Incorporated Place ¹
■	Census Designated Place ¹
■	Voting District ²
●	SLD-Senate
▲	SLD-House

Abbreviation Reference: AIR - American Indian Reservation; SDAISA - State Designated American Indian Statistical Area

¹ A "*" following a place name indicates that the place is coterminous with a MCD. A "-" indicates that the place is also a MCD. In both cases, the MCD name is shown only when it differs from the place name.
² A "*" following a VTD code indicates an actual voting district. Its absence indicates that the VTD is a pseudo voting district or no information is available as to its status.

Voting Districts

Code	Name
4*	BigCreek&Rapard Voting District
9*	Davis Voting District
14*	HoneyCreek Voting District
20*	WhiteOak Voting District

38 304582N
94 096718W

38 304582N
94 096718W

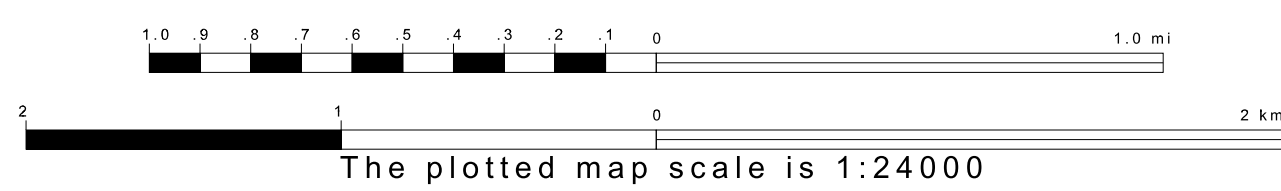
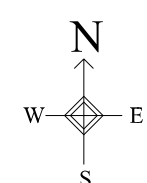

Sheet Location within County

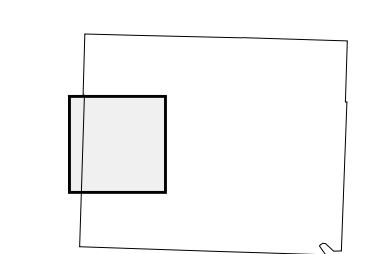

Key to Adjacent Sheets

1	2
4	5
7	8

ST: Missouri (29)
 COU: Henry (083)
 SHEET 4 OF 9 PARENT SHEETS

