

P. L. 94-171 COUNTY BLOCK MAP (CENSUS 2000)

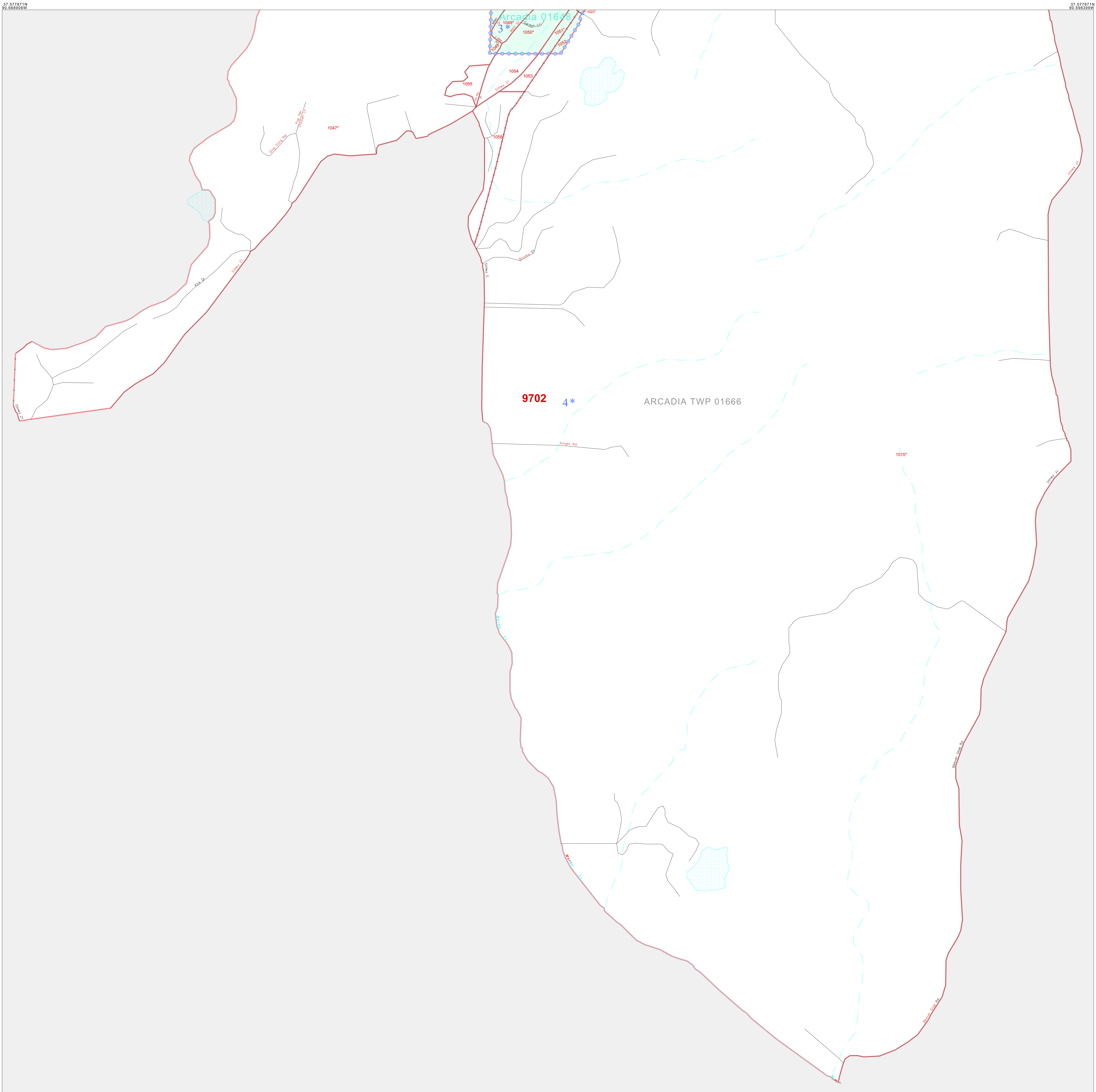

GEOGRAPHIC AREAS LEGEND
SYMBOL NAME STYLE
INTERNATIONAL
STATE
COUNTY
MINOR CIVIL DIV'
Incorporated Place
Census Designated Place
Corporate Offset Boundary
Voting District
Census Tract
BLOCK
Military Inset Out Area

1 A "\*" following a place name indicates that the place is coextensive with a MCD. A "-" indicates that the place is also a false MCD. In both cases, the MCD name is shown only when it differs from the place name.
2 A "\*" following a VTD code indicates an actual voting district. Its absence indicates that the VTD is a pseudo voting district or no information is available as to its status.
3 A "-" following a block number indicates that the block number is repeated elsewhere in the block.

37 522096N 90 668906W 37 522096N 90 668906W

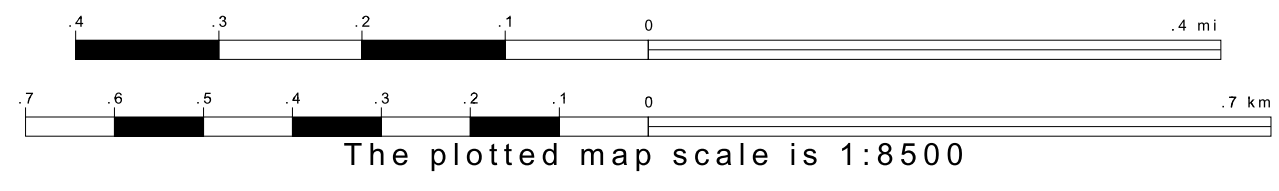
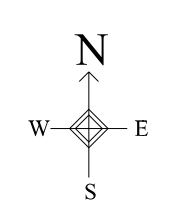

Sheet Location within County

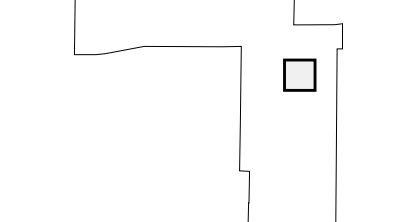

Key to Adjacent Sheets

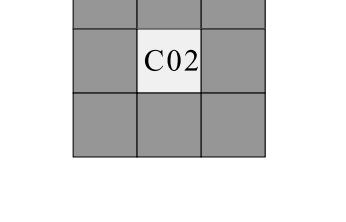

ST: Missouri (29)
COU: Iron (093)
INSET SHEET C02

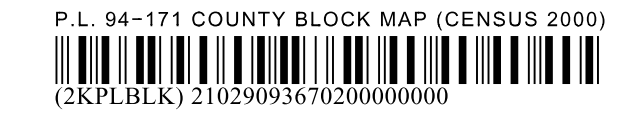

All legal boundaries and names are as of January 1, 2000. The boundaries shown on this map are for Census Bureau statistical data collection and tabulation purposes only; their depiction and designation for statistical purposes does not constitute a determination of jurisdictional authority or rights of ownership or entitlement. U.S. DEPARTMENT OF COMMERCE Economics and Statistics Administration U.S. Census Bureau