

P.L. 94-171 VOTING DISTRICT/STATE LEGISLATIVE DISTRICT OUTLINE MAP (CENSUS 2000)

37 586721N
90 959592W

37 586721N
90 959592W

GEOGRAPHIC AREAS LEGEND

SYMBOL	NAME STYLE
*****	INTERNATIONAL
//////	STATE
□□□□□□	COUNTY
○●○●○●	MINOR CIVIL DIV. ¹
■	Incorporated Place ¹
■	Census Designated Place ²
—	Voting District
●●●●●●	SLD-Senate
▲▲▲▲▲▲	SLD-House

Military
 Inset
 Out Area

Abbreviation Reference: AIR - American Indian Reservation; SDAISA - State Designated American Indian Statistical Area

¹ A "*" following a place name indicates that the place is coterminous with a MCD. A "-" indicates that the place is also a false MCD. In both cases, the MCD name is shown only when it differs from the place name.
² A "*" following a VTD code indicates an actual voting district. Its absence indicates that the VTD is a pseudo voting district or no information is available as to its status.

Voting Districts

Code	Name
4*	Arcadia/Rural Voting District
9*	Hogan/Dunes Voting District

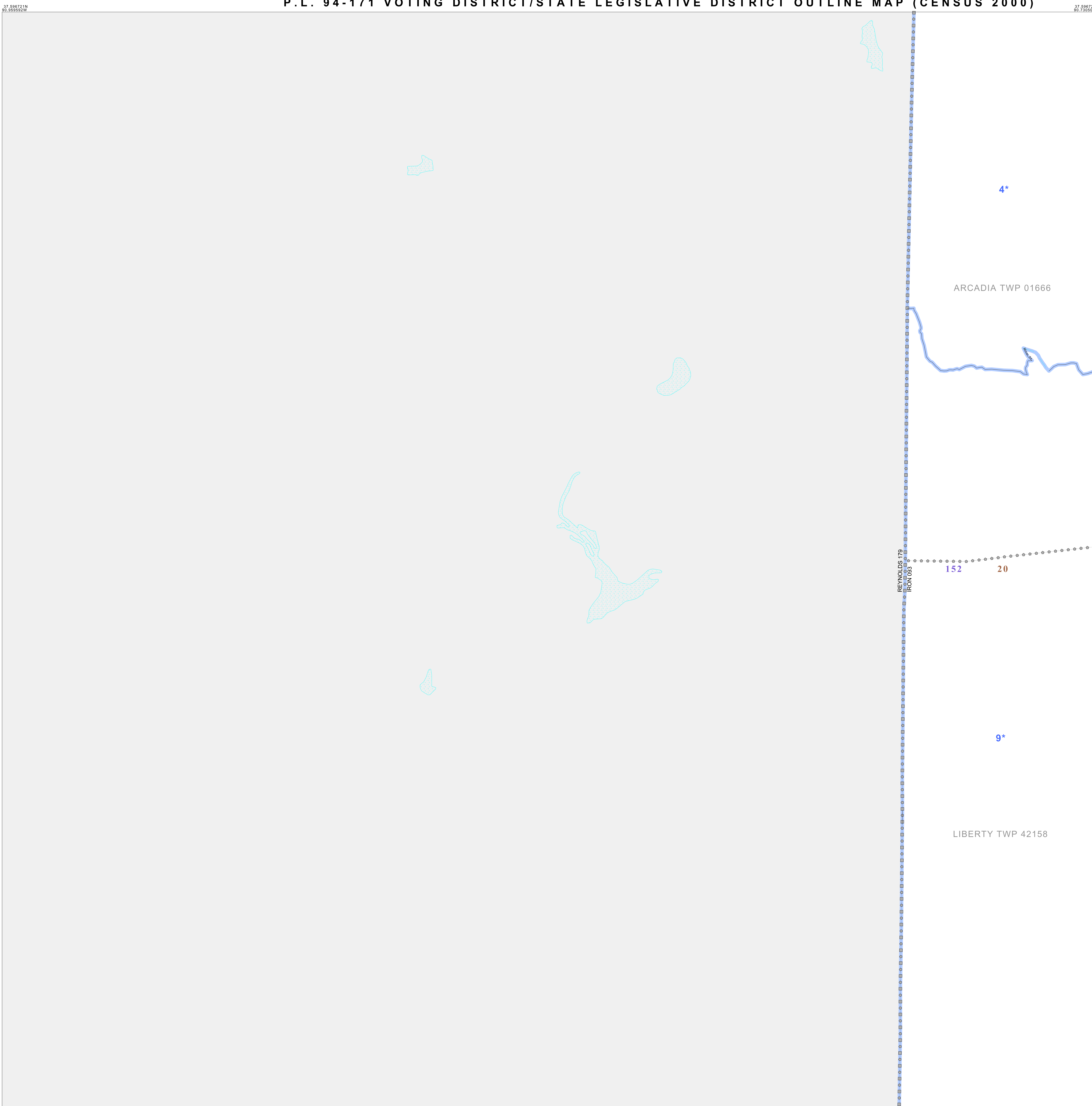

37 414205N
90 959592W

37 414205N
90 959592W

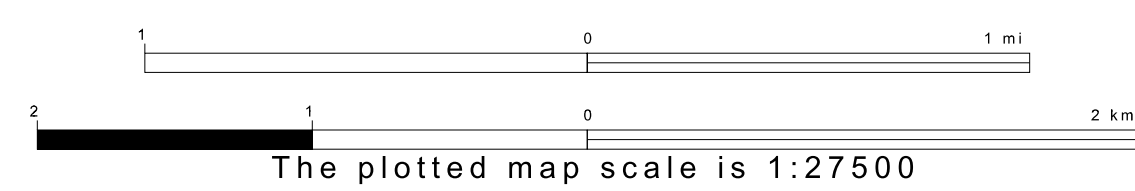

Sheet Location within County

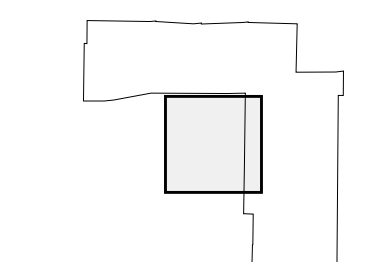

Key to Adjacent Sheets

1	2	3
4	5	6
7	8	

ST: Missouri (29)
 COU: Iron (093)
 SHEET 5 OF 8 PARENT SHEETS

