

P.L. 94-171 VOTING DISTRICT/STATE LEGISLATIVE DISTRICT OUTLINE MAP (CENSUS 2000)

37 445162N
94 233882W

37 445162N
94 036740W

GEOGRAPHIC AREAS LEGEND

SYMBOL	NAME STYLE
*****	INTERNATIONAL
//////	STATE
□□□□	COUNTY
○●○●	MINOR CIVIL DIV ¹
■	Incorporated Place ¹
■	Census Designated Place ²
■	Voting District
●●●●	SLD-Senate
▲▲▲▲	SLD-House
□	Minority
□	Inset
□	Out Area

Abbreviation Reference: AIR - American Indian Reservation; SDAISA - State Designated American Indian Statistical Area

¹ A " " following a place name indicates that the place is coterminous with a MCD. A " " indicates that the place is also a MCD. In both cases, the MCD name is shown only when it differs from the place name.

² A " " following a VTD code indicates an actual voting district. Its absence indicates that the VTD is a pseudo voting district or no information is available as to its status.

Voting Districts

Code	Name
48*	Lincoln Voting District
62*	Sheridan Voting District

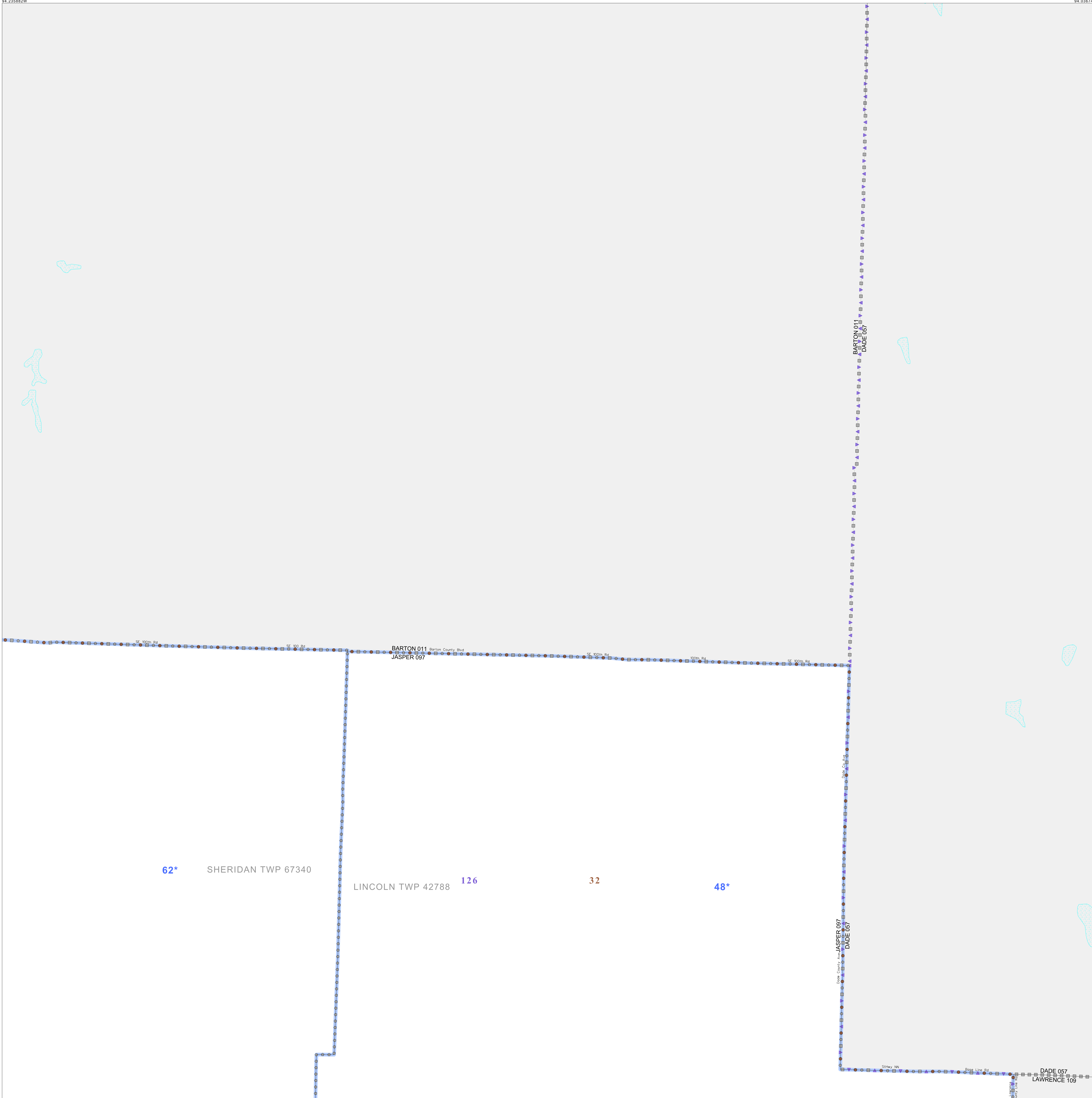

37 285867N
94 233882W

37 285867N
94 036740W

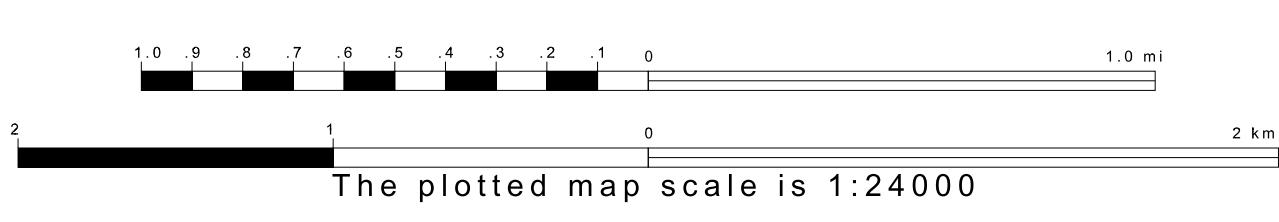

Sheet Location within County

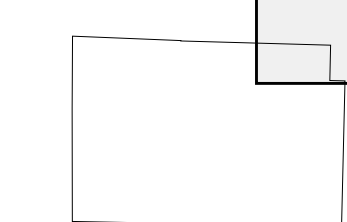

Key to Adjacent Sheets

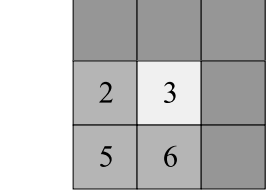

ST: Missouri (29)
COU: Jasper (097)
SHEET 3 OF 9 PARENT SHEETS

