

P.L. 94-171 VOTING DISTRICT/STATE LEGISLATIVE DISTRICT OUTLINE MAP (CENSUS 2000)

37 890805N
90.769406W

37 890805N
90.568217W

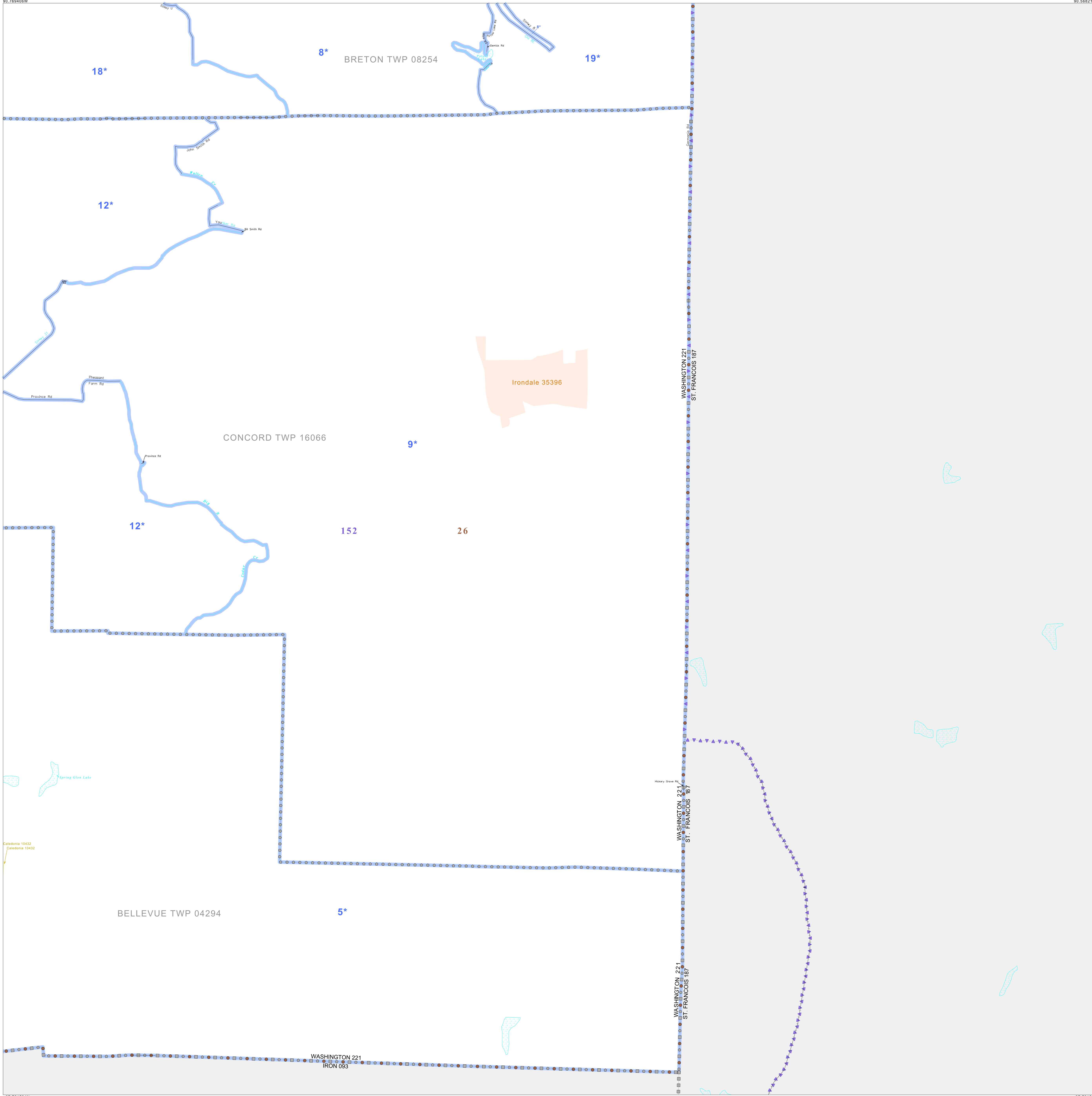

GEOGRAPHIC AREAS LEGEND

SYMBOL	NAME STYLE
*****	INTERNATIONAL
//////	STATE
■■■■■	COUNTY
○○○○○	MINOR CIVIL DIV. ¹
■■■■■	Incorporated Place ¹
■■■■■	Census Designated Place ²
■■■■■	Voting District
●●●●●	SLD-Senate
▲▲▲▲▲	SLD-House
□□□□□	Minority
□□□□□	Inset
□□□□□	Out Area

Abbreviation Reference: AIR = American Indian Reservation; SDAISA = State Designated American Indian Statistical Area

¹ A "*" following a place name indicates that the place is consecutive with a MCD. A "-" indicates that the place is also a false MCD. In both cases, the MCD name is shown only when it differs from the place name.

² A "*" following a VTD code indicates an actual voting district. Its absence indicates that the VTD is a pseudo voting district or no information is available as to its status.

Voting Districts

Code	Name
5*	Caledonia Voting District
8*	Hopewell Voting District
9*	Irondale Voting District
12*	Osarkheights Voting District
18*	Springtown Voting District
19*	StonyPoint Voting District

37 731531N
90.769406W

37 731531N
90.568217W

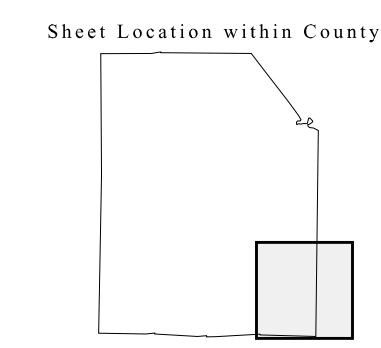
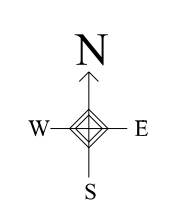

Key to Adjacent Sheets

5	6
8	9

ST: Missouri (29)
COU: Washington (221)
SHEET 9 OF 9 PARENT SHEETS

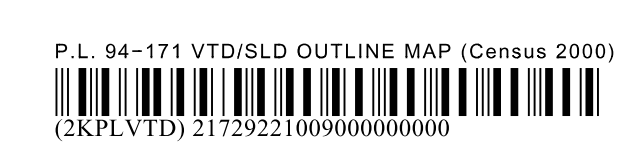

All legal boundaries and names are as of January 1, 2000. The boundaries shown on this map are for Census Bureau statistical data collection and tabulation purposes only; their depiction and designation for statistical purposes does not constitute a determination of jurisdictional authority or rights of ownership or entitlement. U.S. DEPARTMENT OF COMMERCE Economics and Statistics Administration U.S. Census Bureau