

P. L. 94-171 COUNTY BLOCK MAP (CENSUS 2000)

38 365312N
91.749150W

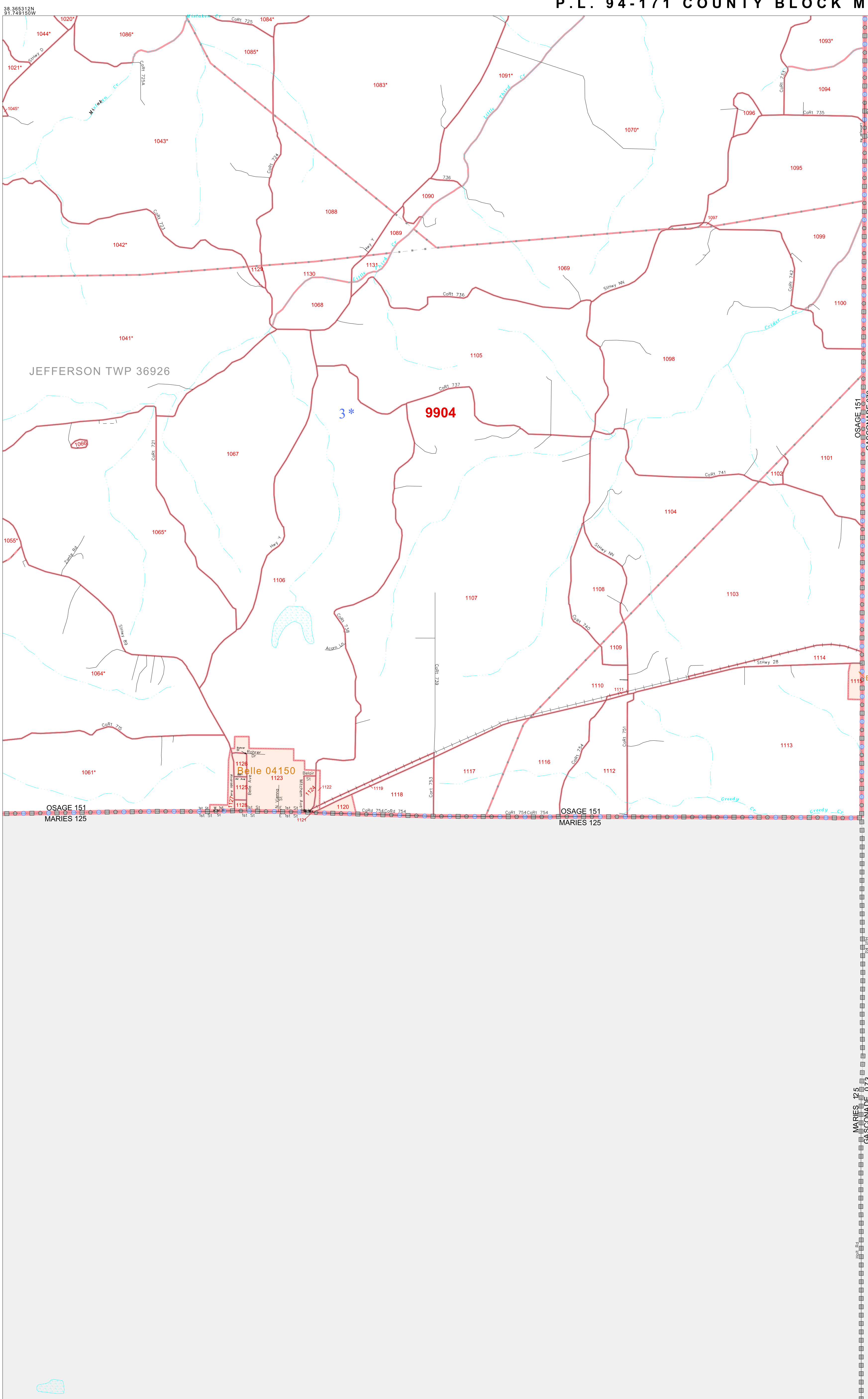

GEOGRAPHIC AREAS LEGEND

SYMBOL	NAME STYLE
*****	INTERNATIONAL
//////	STATE
□□□□	COUNTY
□□□□	MINOR CIVIL DIV ¹
■ ■ ■ ■	Incorporated Place ²
■ ■ ■ ■	Census Designated Place ²
-----	Corporate Offset Boundary
●●●●	Voting District ³
—	Census Tract
—	BLOCK ³

1 A "*" following a place name indicates that the place is coterminous with a MCD. A "-" indicates that the place is also a false MCD. In both cases, the MCD name is shown only when it differs from the place name.

2 A "*" following a VTD code indicates an actual voting district. Its absence indicates that the VTD is a pseudo voting district or no information is available as to its status.

3 A "*" following a block number indicates that the block number is repeated elsewhere in the block.

Military Inset Out Area

38 232596N
91.749150W

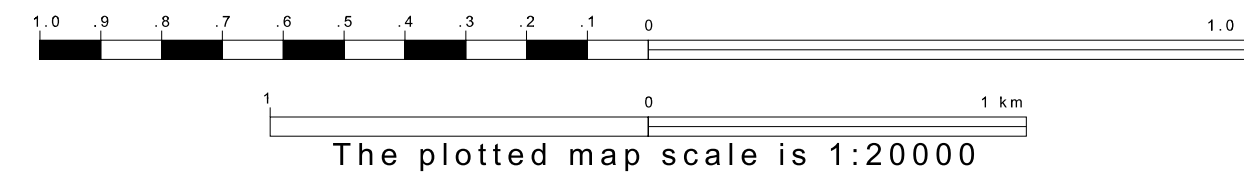
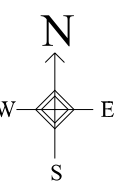

Sheet Location within County

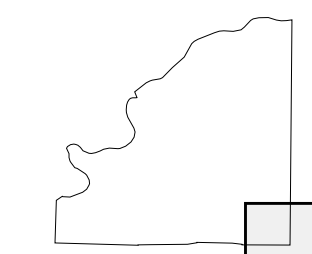

Key to Adjacent Sheets

8	9
12	13

ST: Missouri (29)
COU: Osage (151)
SHEET 13 OF 13 PARENT SHEETS

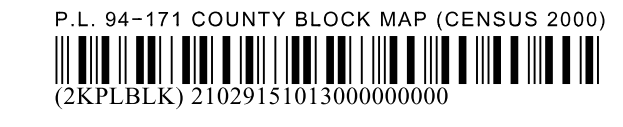

38 232596N
91.749150W