

GEOGRAPHIC AREAS LEGEND

| SYMBOL | NAME STYLE |
|--------|--------------------------------------|
| ***** | INTERNATIONAL |
| ////// | STATE |
| □□□□ | COUNTY |
| ○●○● | MINOR CIVIL DIV ¹ |
| ■ | Incorporated Place ¹ |
| ■ | Census Designated Place ² |
| — | Voting District |
| ●●●● | SLD-Senate |
| ▲▲▲▲ | SLD-House |
| □ | Minority |
| □ | Inset |
| □ | Out Area |

Abbreviation Reference: AIR - American Indian Reservation; SDAISA - State Designated American Indian Statistical Area

¹ A "*" following a place name indicates that the place is coterminous with a MCD. A "-" indicates that the place is also a false MCD. In both cases, the MCD name is shown only when it differs from the place name.
² A "*" following a VTD code indicates an actual voting district. Its absence indicates that the VTD is a pseudo voting district or no information is available as to its status.

Voting Districts

| Code | Name |
|------|------------------------------------|
| 2* | BigPiney Voting District |
| 3* | CaveSpring Voting District |
| 4* | Crocker Voting District |
| 5* | Green Voting District |
| 6* | St Robert/FortWood Voting District |
| 7* | Hucker Voting District |
| 10* | St Robert Voting District |
| 11* | Waynesville Voting District |

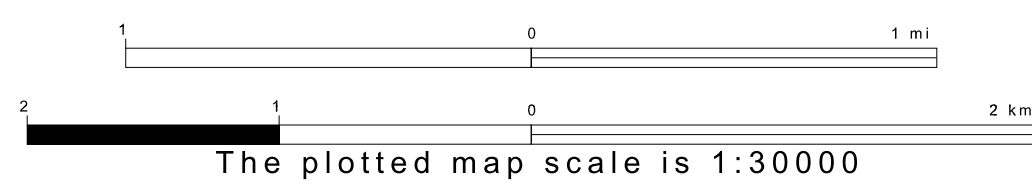
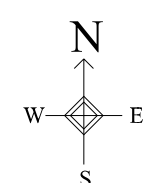

Sheet Location within County

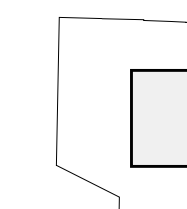

Key to Adjacent Sheets

| | |
|---|---|
| 1 | 2 |
| 3 | 4 |
| 5 | 6 |

ST: Missouri (29)
 COU: Pulaski (169)
 SHEET 4 OF 6 PARENT SHEETS

